



EAST SUSSEX HISTORIC BUILDINGS RECORD

(Incorporating Rape of Hastings Architectural Survey)

*Research into and dissemination of information relating to
historic buildings of pre-1750 date in the eastern three Rapes of Sussex*

ESRO HBR 9/41

TENEMENT ANALYSIS

SEDLESCOMBE (P41)

**Version 4
Analysis as in 2010**

IMPORTANT NOTE

All details should be checked before use in any published article.

Land tax has NOT been sampled, nor have most

Tithe Award entries have been entered.

**Other documentary sources not used in the preparation
of this document (including many additional manorial records)
are available at the Record Office and elsewhere.**

Some references on the record cards were incomplete or outdated.

**This document does not contain entries specifically
relating to listings and surveys of surviving buildings**

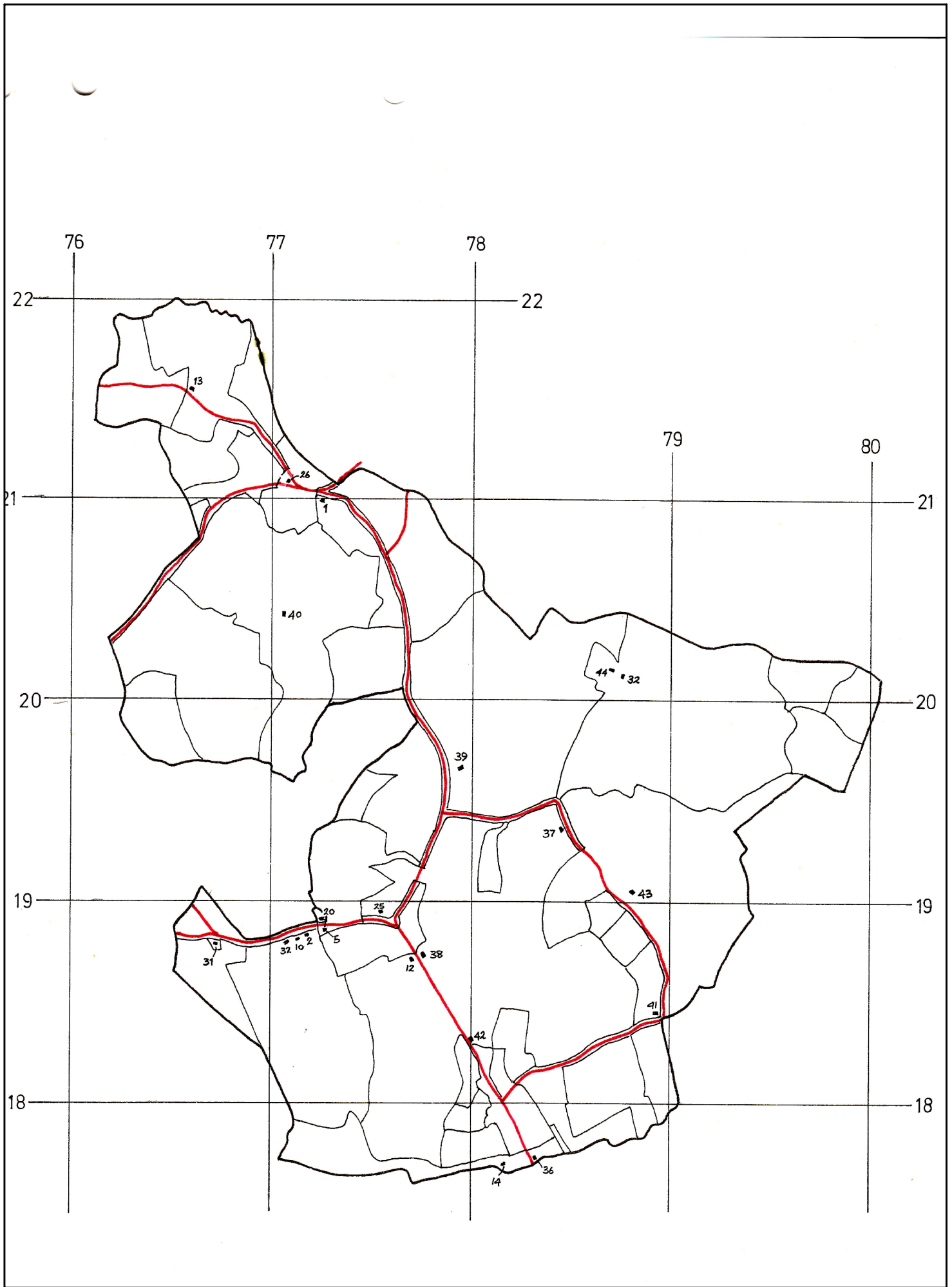



NO	PRESENT NAME	OLD NAMES	NGR TQ	SURVIVAL		
				S	R	D
1	LITTLE SWALES GREEN		7725 2100.	X		
2	SPILSTEADS COTTAGE	GUNNS	7718 1884	X		
3	QUEENS HEAD		V 7818 1798	X		
4	WOODMANS COTTAGE		7806 1822	X		
5	DURNANFORD	STREAM TANHOUSE	7728 1884	X		
6	BRICKWALL.		V 7814 1804	X		
7	HOLMES HOUSE		V 7822 1790	X		
8	HOMESTALL HOUSE		V 7818 1780	X		
9	MANOR COTTAGES		V 7807 1804	X		
10	SPILSTEADS		7714 1879	X		
11	HARRIET HOUSE		V 7821 1792	X		
12	BEECH HOUSE	BEECHES	7770 1869	X		
13	STRAWBERRY HILL	BELATKYNS	7959 2152	X		
14			7815 1768			
15	SACKVILLE COTTAGES		V 7816 1786	X		
16	FORGE COTTAGES		V 7823 1788	X		
17	ROSEHILL COTTAGE		V 7802 1818	X		
18	COACH & HORSES		V 7827 1778	X		
19	ASSELTON.		V 7823 1791	X		
20	LITTLE HANCOX		7725 1891	X		
21	OLD THATCH.		V 7821 1777	X		
22	OLD GUNHOUSE		V 7806 1817	X		
23	DURUD.		V 7814 1794	X		
24	ILTONS BETH etc		V 7826 1780	X		
25	LITTLE CASTLEMANS		7755 1887	X		
26	SWALES GREEN F ⁿ		7710 2106	X		
27	GREGORY'S OLD BAKERY		V 7824 1779	X		
28			V 7811 1799	X		
29	TANYARD HOUSE & STORES		V 7827 1777	X		
30	SHERRALD		V 7814 1792	X		
31		WICKHAM MILBOROWE	7671 1881	X		
32	AUSFORD	AMYOTTS ASFORD	V 7875 2012	X		
33		N. of Brickwall	V 7810 1820	X		
34		MOTKINS Adj. Brickwall	V 7810 1810	X		
35		N. of Howick Lane	V 7820 1794	X		
36			7832 1770	X		
37		KILLINGHAM	7846 1938	X		
38	CASTLEMANS		7776 1874	X		
39	GREAT SAUNDERS		7795 1969	X		
40	FOOTLANDS	FOOTLANDS	7705 2043	X		
41	BREDE BARN F ⁿ	MABBS.	7895 1844			
42	SEDLESCOMBE SCHOOL		7800 1830	X		
43	HURST	HURST	7881 1905	X		
44	AUSFORD	ASFORD	7867 2014			X
45	THE COTTAGE		V 7815 1789	X		
46	^{TREE} FIR COTTAGE		V 7817 1786	X		
47	N. of Brickwall		V			
48	SCOTTS DOWNE					
49	BRICKWALL	LUCKWISH	7712 1875			X
50	ROEHILL					
51	WINDLEFOTTS		7666 2078	X		

**SEDLESCOMBE - LITTLE SWALES GREEN [P41/1]
NGR TQ 7725 2100**

DETAILS OF THE PROPERTY

DETAILS OF THE BUILDINGS

Surveyed

See ESRO HBR 1/1139

LAND TAX ASSESSMENTS [1]

DETAILS OF OWNERSHIP

DETAILS OF TENANCY

SOURCES marked [] at end of entry.

1. ESRO ELT - Sedlescombe

**SEDLSCOMBE - SPILSTEADS COTTAGE [P41/2]
NGR TQ 7718 1884**

Two tenements of Battle manor called Gunns, qr 2s.0d + Wickham (ex-demesne), qr 26s.8d

DETAILS OF THE PROPERTY

1367-1367+		In 1367 the owner of this property took three leases on Marley demesne lands and one of these, called Wickham, (possibly all three combined as one) was subsequently converted into a freehold [2]
<1382-1569+	Ho + c54a	Described in 1382 as a messuage and lands at Durhamford + 54 acres of demesne <called Wickham> [2] Given in 1569 manor survey as amessuage and barn (0a.2r.) called Gunns + 50 acres called Wickhams [4]
<1724-1724+	Ho, bn + 0a.2r.	Described in 1724 manorial document as a house, barn + 0a.2r called Gunns [5]. By this date Wickham had been merged into adjacent Spilsteads Farm.

DETAILS OF THE BUILDINGS

Surveyed	see ESRO HBR 1/336
----------	--------------------

LAND TAX ASSESSMENTS [1]

DETAILS OF OWNERSHIP

<1367-1382	John	Gunn I	His death was presented in Battle manor court in 1382 holding the freehold at Durhamford and demesne held at an annual rent of 28s.8d [2]
1382-1391	John	Gunn II	Son of John I, from whom he inherited. His death was presented in Battle manor court in 1391 [2]
1391-1391+	Robt	Hammond	He held in the right of hiswife, Florence, daughter of John Gunn I and brother of John Gunn II [2]
<1433	Simon	Hammond	Son and heir of Robert [2]
<1433-1433+	Thos	Hammond	[3]
<1569-1569+	John	Bishop	[4]
<1724-1724+	Will	Bishop, esq	[5]

DETAILS OF TENANCY

SOURCES marked [] at end of entry.

1	ESRO	ELT - Sedlescombe
2		Searle, Battle Abbey and its Banlieu, pp.324,331-332
3	ESRO	BAT 40 - Battle manor survey, 1433
4	ESRO	BAT 42- Battle manor survey 1569, T78, T79
5	ESRO	BAT 4421/4

**SEDLSCOMBE - THE QUEENS HEAD [P41/3]
NGR TQ 7818 1798**

Copyhold of Battle manor held at a quitrent of 18d.

DETAILS OF THE PROPERTY

Part A

<1367-1433+ Ho Described in a rental of 1367 as William Baker for his own messuage lying next to the messuage of Thomas Hucksteep, quitrent 4½d x 4 [5].
Described in survey of 1433 as a messuage and curtilage formerly William Baker, quitrent 1/6d. Abuts:- N = road Iltonsbath to Brede; S = messuage of Thomas Harry [P41/3 part B]; E = Robert Morris's Martins Town [see P41/48]. [9]

Part B

<1367-1433+ Ho Described in a rental of 1367 as a messuage and curtilage formerly John Brydd [5]
Describe in survey of 1433 as a messuage and curtilage formerly John Seyr, quitrent 1/6d. Abuts:- N = William Baker [P41/03 part A]; S = the same ownership as this property [P41/35]; E = Robert Morris [see P41/48] [9].

Both Parts

<1493-1493+ 2 Mess Described in the court records of 1493 as two copyhold messuages [4]
<1510-1510+ 2 Ho + 1 cot Described in a court entry of 1510 as a bondhold messuage and curtilage [P41/19], the moiety of a bondhold messuage [part of this property], a bondhold croft of land called Martins Town [part of this property] and a bondhold cottage and a garden lately in the lords hands [part of this property], and a bondhold croft called Wedyottescrofte, all at Iltonsbath, four oxen given as heriots, ie. for the said three messuages and Martins Town [4].
<1521-1548+ Ho + gdn Described in a court entry of 1521 as a bondhold messuage with a curtilage and appurtenances at Iltonsbath. Abuts:- W = high street; N = lane between Iltonsbath and Brede [4]
Described in a court entry of 1548 when granted by the lord as being a messuage, curtilage and garden in Iltonsbath., quitrent 1/6d at two annual terms. Abuts:- W = high road; N = lane to Brede; S = messuage and garden late Richard Harrys [P41/48]; E = croft called Martins Town [4]
<1569-1569+ Ho + gdn Described in the survey of 1569 as a messuage and garden (3r). [1]. Described in 1721 as a copyhold house and land in Sedlescombe [3]
<1595-1680+ Described in the rentals of 1595 to 1704 as a messuage, quitrent 1/6d + a close of pasture called Martins Town, quitrent 1/- + a garden where sometime was a tenement, quitrent 1/6d [6].
<1704-1730+ By 1704 the close called Martinstown, (quitrent 1/-) and a garden sometime a tenement, (quitrent 1/6d) had been sold and merged into P41/06 [6,7].
The 1724 map shows this property as a house and 0a.1r.22p. [2]. That part sold to Mercer is shown as a plot of 1a.0r.29p. with a building standing on a divided off part by

the road, + a 2a.0r.10p. plot called Martinstone [2].

DETAILS OF THE BUILDING

15C

The Queens Head was surveyed by D and B Martin in 1978.
For an archaeological report on the building see ESRO
HBR 1/0335.

LAND TAX ASSESSMENTS

DETAILS OF OWNERSHIP

Part A

<1367-1367+	Will	Baker	Given as the owner in a rental of 1367. It is unlike that this is the same William Baker who owned the property in 1412 [5].
<1412-1433+	Will	Baker	[9] Of Iltonsbeth in 1412 when he surrendered the property to the use of his wife [after his death] [4]

Part B

<1367	John	Brydd	Given as a late owner in the rental of 1367 [5]
<1367-1367+	Thos	Hucksteep	Given as the owner in the rental of 1367 [5]
<1433-1433+	Thos	Harry	He also owned P41/35 which was adjacent [9]

Both Parts

<1493-1493	John	Daniel	He surrendered two copyhold messuages to his brother [4]
1493-1510	Alan	Daniel	Brother of John [4] His death was presented in 1510 [4]
1510-1522+	John	Daniel	His son is given as heir who was a minor. He was admitted in 1522 when became of full age [4]
<1548-1548		Lords hands	[4]
1548-1557	Rich	Brown	He and his wife Agnes were granted this property by the Lord in 1548 [4]. He died holding the property in 1557 [4]
1557-1557+	John	Brown	[4]
<1569		Brown	[] Brown's heirs held the property in 1569 [1]
<1583-1583	Agns	Brown, widow	Widow of Richard Brown. Her death was presented in 1583 holding a tenement and garden called Harrys [6]
1583-1583	John	Brown	Son of Richard and Agnes; he immediately surrendered to Richard Boyes [6]
1583-1639+	Rich	Boyes	[6]
<1652-1654	Pet	Farnden, esq	His death was presented in 1654 and his heirs held the property in 1680 [6,8]
1654-1655+		Farnden, heirs of	Upon the death of Peter Farnden the property descended first to his wife, Lucy, and then to his nephew, Peter Farnden [8]
<1659-1659+	Pet	Farnden, gent	Nephew of Peter Farnden [8]
<1704-1704+	Jos	Mercer	[6]
<1721-1721	Robt	Braban, gent	Of Sedlescombe in 1721 [3]
1721-1721	Will	Braban	As guardian of his son William Braban [3]. William Braban was admitted in 1721 as devisee of his uncle Robert Braban of Sedlescombe, gent [3].
1721-1730+	Thos	Snepp, gent	[7]. Of Etchingham in 1721 when he and his wife Anna acquired the property [3]. By 1724 he had sold off the land to Joseph Mercer [2]

DETAILS OF TENANCY

<1493-1493+ John Daniel +
Alan Daniel

According to the court records they occupied the two
messuages [4]

SOURCES marked [] at end of entry.

1. ESRO BAT 42, T. 91
2. ESRO BAT 4421/9
3. ESRO AMS 5729/97 and 98.
4. ESRO XA3/4, 3116, 2590. Court roll.
5. ESRO XA3/13 - rental of Iltons bath, 1367.
6. ESRO HEH BA Vol. 23 (Rentals of 1595 and 1639) Vol 24 (Rental of 1652), Vol 25 (Rental of 1680) and Vol. 99 (Rental of 1704).
7. ESRO BAT 47 - Rental of 1730.
8. ESRO BAT 18
9. ESRO BAT 40.

**SEDLSCOMBE - WOODMANS COTTAGE [P41/4]
NGR TQ 7806 1822**

DETAILS OF THE PROPERTY

DETAILS OF THE BUILDING

E/M 18 C

The house was surveyed by D & B Martin in 1978 and a brief archaeological report was produced. See ESRO HBR 1/0333.

LAND TAX ASSESSMENTS

DETAILS OF OWNERSHIP

DETAILS OF TENANCY

SOURCES marked [] at end of entry.

**SEDLSCOMBE - DURHAMFORD MANOR [P41/5]
NGR TQ 77280 18840**

Alternative names:- Tanhouse; Durhamford; Stream Farm.

DETAILS OF THE PROPERTY

<1611-1611+	Ho + c143 acres	In 1611 William Bishop was taxed in Sedlescombe Borough for the Tanhouse where he lives + 30 acres of land, + more for 60 acres called Moones & Hurst + more for 16 acres called Kippings Field, + more for 9 acres called Gillians Field & Churchlands + more for Hoorneland. Total 143 acres [2]. In 1632 the property was called 'Durhamford House' [3]. In the glebe terrier of 1635 this property is described in an abutment as 'the Tanhouse called Durhamford' [7].
<1746-1746+	Ho, bn + c.35a.	Described in a deed to bar entails dated 1746 as a message or tenement, backside, garden, orchard, barn, close and land (c35a.) known as Durhamford als Tanhouse [9]. Note:- This acreage excludes Combe Wood.
<1759-1759+	Ho, bn + c.59a.	Detailed map of Tanhouse Farm, dated 1759, shows the house, barn + 58a.3r.23p. land. Note:- This acreage includes Combe Wood (19a.3r.30p). Field names and acreages given. The house, barn + 1a.1r.04p were detached from the other lands, being located upon the opposite side of the road. The site of the house, barn and garden very much look as if they had originally been taken out of wayside wasteland, though if this is so, it happened very early.
<1815-1843+	Ho, bn + c.39a.	Described in conveyance of 1815 as 'a message or tenement with backside, garden, orchard, barn, close and several pieces of land . . . ' being 38a.2r.15p called Durhamford otherwise Tanhouse [9]. Note:- This acreage excludes Combe Wood. Described in the tithe award as a house, garden, homestead + 39a.0r.17p. called Durhamford Farm. Schedule gives field names and acreages. Map shows individual fields and buildings [10].

DETAILS OF THE BUILDINGS

Surveyed See ESRO HBR 1/98

LAND TAX ASSESSMENTS [1]

1731-1750	£18	
1751-1752	£19	
1755-1775	£20	Called 'Tanhouse Farm' 1755-1775.
1780	£45	This = Durhamford (£20) + Hurst (£25).
1785	£78	
1790-1843	£30	Called 'Tanhouse' in 1835.

DETAILS OF OWNERSHIP

<1611 Bishop family It seems likely that the Bishop family had owned this property since

at least the middle of the 15th century. This assumption is based upon the fact that two ancient tannery sites are known within Sedlescombe parish, this site and that owned by Battle Abbey to the west of Sedlescombe Street, at its southern end. Another was later set up to the east of Sedlescombe Street. Both of these latter sites were located within Battle Hundred, whilst that at Durhamford is the only known site in Sedlescombe parish in the hundred of Staple. In 1447 William and Alexander Bishop were presented as tanners within the Sedlescombe Borough of Staple Hundred [5].

<1731-1746+	Hen	Bishop, esq.	Of Great Sanders in Sedlescombe [1,9]. In 1746 he and his son barred the entail on part of the estate, including this property. The properties concerned may give an indication as to the earlier development of the estate (though equally there could have been an earlier marriage portion) and therefore they are listed here. They comprised Barn and land (40a.) in Battle, in occupation of John Reynolds; Four pieces of woodland adjoining to the last in Battle (28a.); Messuage, barn and land (c35a.) called Durhamford also Tanhouse in Sedlescombe in the occupation of Simon Watson; Woodland called Coomb Wood (18a.) in Sedlescombe; Messuage, barn and land (77a.) called Beach Farm in Sedlescombe and Whatlington in the occupation of William Fuller; Five pieces of Woodland, part of the last mentioned farm, called Orchard Wood, Marlpit Wood, The Little Thorps, Kemp Wood, and Beach Farm Wood (28a.) in Sedlescombe and Whatlington; Messuage, barn, oasthouse and lands (80a.) called Hurst in Sedlescombe in the occupation of William Young; Woodland adjoining the last called Church Land Wood, The Hurst Wood, The Moon Wood, The Seven Acres Shaw, (66a.) in Sedlescombe; also Woodland called Ausford Wood als Alsford Wood, Wards Wood, Round Wood, Gilly Shaw, The Brock Wood, Woodlands Wood (89a.) in Sedlescombe; also Five pieces of wood called Holly Wood, Hoorne Wood, The Brempp Wood, Green Den Wood, and The Street Field Wood (184a.) in Ewhurst; also Woodland called Birchen Wood (20a.) in Ewhurst and Sedlescombe [9].
<1759-1780+	Will	Bishop, esq.	Of Great Sanders in Sedlescombe [1,6]. Eldest son of Henry [9]. On his impending marriage to Philadelphia Roberts of Sedlescombe, spinster, William conveyed part of Great Sanders Estate (<i>viz</i> Durhamford, Chittlebirch, Beach) to his brother in trust for himself as his wife's marriage portion [9].
<1783-1784	John	Bishop, clerk	Of Sedlescombe. Brother of William [9]. John inherited the entire Great Sanders estate upon the death of his brother [9]. He made his will 3/11/1783 (proved 28/5/1784) leaving the entire estate to his son, James [9]. At the time of his death he was living in the mansion at Great Sanders [9].
1784-1802	Jas	Bishop, esq.	Of Great Sanders in Sedlescombe [1,9]. Son of John [9]. By will dated 27/2/1802 he left the property to his first son, John [9].
1802-1815	John	Bishop, esq	Of Great Sanders in Sedlescombe
1815-1843+	John	Pratt, Rev.	[1] First son of James [9]. In 1815 he sold 'Durhamford als Tanhouse' to Rev John Pratt for £1,652 [9]. Of Sedlescombe [1,9,10]

DETAILS OF TENANCY

<1611-1611+	Will	Bishop	[2,7]. William was taxed in the poor rate in that year at 3/6d, compared with 10/- for Richard Bishop, who was presumably of Great Saunders [4].
<1632-1632+	Thos	Pooke	In 1632 he occupied the pew in the church for Durhamford House and maintained the fence for the same [3].
<1642-1653+	Rich	Bishop gent (?)	Un-confirmed occupier of this property. In 1642 he

contributed 10/- to the relief of the Irish Protestants, with three others the joint sixth highest contribution out of a total of 84 contributing parishoners. William Bishop, gent (of Great Sanders) contributed 20/- [8]. In 1653 he was rated at 4/-, compared with 10/- for William Bishop, who was presumably of Great Saunders [4]. It is possible that Richard was living at Hurst Farm at this date.

<1713-1715	John	Clark
1715-1717	Thos	Nabbs
1718-1732	John	Henley
1733-1740+	Edwd	Watson
<1746-1752+	Sim	Watson
<1755-1765+	Mlry	Bishop

He occupied this property with Chittlebirch Farm [4].

[4]

[1,4]

[1,4]

[1,9]

Mlry = Mallory

[1]. In the poor rates he is styled Mr Mallory Bishop – he was probably Henry Mallory Bishop, who was a lawyer [4].

<1769-1790+	Will	Cook
<1795-1795+	Rich	Eldridge
<1800-1800+	Will	Eldridge
<1810-1820		Eldridge
<1830-1843+	John	Pratt, Rev.

[1,9]

[1,9]

Described as late William Eldridge in 1805 [1,9]

[1]

[1] In addition to Durhamford, he also occupied The Parsonage and Glebe [10]. It is possible that already by this date he lived in the Parsonage with three tenants in Durhamford. He later moved to Beech House.

SOURCES marked [] at end of entry.

1. ESRO Sedlescombe Land Tax Returns
2. ESRO FRE 520
3. SAC Vol.52, p.96
4. ESRO PAR 481/9/5-6.
5. SRS Vol. 37, p.147.
6. ESRO AMS 6401 - Map of Tanhouse Farm.
7. WSRO Ep II/17/37 & 38 - Glebe terriers
8. Sx. Genealogical Centre, Occasional Papers 10.
9. HMAG Deeds and Wills of the Bishop Family of Sedlescombe.
10. ESRO Sedlescombe Tithe Award and Map.

**SEDLSCOMBE - BRICKWALL [P41/6]
NGR TQ 7814 1804**

Copyhold of Battle manor, quitrent 12d.

DETAILS OF THE PROPERTY

Part A

- | | | |
|-------------|-----------------|---|
| <1367-1367+ | Ho + land | Described in 1367 as a curtilage of William Motkin formerly Robert Hurstman, quitrent 1½d x 4, + the messuage of William Motkin, quitrent 3d x 4 + a croft lying next to the messuage of the aforesaid William Motkin [5] |
| <1433-1433+ | Ho, curt + land | Described in 1433 survey as a messuage, curtilage and adjacent croft, formerly William Motkyn, quitrent 2/6d. Abuts:- N = Waterland [P41/47]; S = Robert Morris [P41/06 part B]; E = Bakerscroft [for which see P41/48] [11]. |
| <1461-1461+ | Mess + land | Described in court entry in 1461 as a messuage and garden with land adjacent called Motkyns at Iltonsbath [4]
Described in a court entry of 1521 as a messuage and curtilage and three crofts lying together at Iltonsbath. This is tenement 89 in the 1569 survey [4] |

Part B

- | | | |
|-------------|-----------|--|
| <1367-1367+ | Ho | Described in 1367 rental as a messuage formerly Reginald Cowherd, quitrent 3d x 4 [5]. |
| <1433-1433+ | Ho + land | Described in rental of 1433 as a messuage and curtilage late Reginald Cowherd, rent 1/-. Abuts:- N = Thomas Motkin; S = road Iltonsbath to Brede; E = Thomas Motkin. Also a croft formerly William Hucksteep called Martins Town, quitrent 1/-. Abuts:- S = Blackland; N = road Iltonsbath to Brede; W = William Baker [11]. |

Both Parts

- | | | |
|-------------|-------------------------|--|
| >1521 | Property added | By 1542 a messuage to the south (part B above) had been added. [1,4] |
| <1542-1569+ | 2 Hos + gdn | Described in a court entry of 1542 as a messuage, curtilage and land in Iltonsbath, quitrent 12d + messuage, curtilage and croft in Iltonsbath, rent 2/6d [4].
Described in 1569 as a newly built messuage and garden being ½ acre, quitrent 12d. Abuts:- N,E = messuage of the same ownership as this property; S, W = highway Tiltonsbath to Brede. Also a copyhold tenement with a barn and three closes of pasture (3 ares) called Motkins, quitrent 2/6d. Abuts of the messuage:- N = messuage of the heirs of Comber [P41/47]; S = another messuage of the same ownership as this property [ie. that mentioned above]. Abuts of the 3 closes:- N = lands called Waterlands; S = lane between Tiltonsbath and Brede; [] = lands of the heirs of Martin called [] [1] |
| <1595-1704+ | 2 Hos (one goes) + land | Given in the rentals 1595 to 1704 as a tenement called Motkins, quitrent 2/6d + another messuage newly builded quitrent 1/- [6].
In 1654 34a called Blacklands and a brook called Collybrook were acquired from P41/35 and merged into this property [8].
Immediately following the acquisition of Blacklands, the |

owner, Peter Farnden died and his possessions held of Battle Manor were given in the court book as follows:-
 Copyhold called Waterland in Sedlescombe, 20d
 Messuage, barn and garden in Sedlescombe, 18d
 Tenement called Motkins in Sedlescombe, 20d
 Messuage in Sedlescombe late Boyles, 18d
 Close called Martins Town in Sedlescombe, 12d
 Freehold garden once a messuage in Sedlescombe, 18d
 Freehold called Blacklands in Sedlescombe, 4/4d
 Copyhold called Headacres and Halers in Westfield, 5/4d
 Widdotscroft in Westfield, 2d
 Freehold in Glasseye borough [in Beckley] called Ludley and Hayes, 32/2d or 22/2d. [8]

In 1659 Peter Farnden, gent sold the 34a of land called Blacklands and the Brook called Collybrook in Iltonsbath to William Davis of Mountfield [8]

<1807-1807+ Ho + buildings

Shown on a map of 1807 as a house and buildings [3]

DETAILS OF THE BUILDING

1599
E/M20C

Inscription on a chimney of 1599.
House virtually destroyed by fire in the early/mid 20th century.

Surveyed

See ESRO HBR 1/823

LAND TAX ASSESSMENTS

DETAILS OF OWNERSHIP

Part A

<1367-1367+ Will Motkyn

Given as the owner in 1367 rental [5]

<1433-1461 Thos Motkyn

He held the property in 1433 [11]. His death presented in 1461 [4]

1461-1461+ Steph Motkyn

Eldest son and heir of Thomas [4]

Part B

<1367-1367+ Robt Morriss

Given as the owner in 1367 rental [5].

<1433-1433+ Robt Morris

[11]

Both Parts

<1521 Will Castleman

Given as a late owner in 1521 [4].

<1521-1521 Lucs Water

Lucas Water surrendered the property in 1521 [4]

1521-1542 John Vissenden/Fyssynden

John Fyssynden is assessed in the 1524 lay subsidy at £18 [10] His death presented in 1542 [4] John also held a major property near the market in Battle.

1542-1542+ Step Vissenden

Younger son and heir of John Vissenden, he was aged 5 at his fathers death in 1542. Custody was granted to his uncle, Stephen Vissenden the elder, brother of John [4]. Stephen also held a major property near the market in Battle.

<1595-1595+ John Sackville

Stephens heirs held the property in 1569 [1]

<1632-1654 Pet Farnden

He is given as the owner in the rental of 1596 [6]

He occupied a church seat for a messuage lately built called Motkins and repaired a fence for Motkins and Blacklands [2]. Given as owner in the 1639 and 1652 rentals; his heirs

1654-1655+		Farnden, heirs of	are given as owners in 1680 [6] His death was presented in 1654 [8]
<1659-1659+	Pet	Farnden, gent	Upon the death of Peter Farnden the property descended first to his wife, Lucy, and then to his nephew, Peter Farnden [8] Nephew of Peter Farnden [8] Peter Farnden is assessed under the hundred of Battle in hearth tax return at 17 flues, but it has not been confirmed that he was living in Sedlescombe Street, and even if he was this could be a multiple entry for all his houses - the entry is not with the other Sedlescombe street entries in the return and it is therefore possible that this property is assessed under its tenant's name - for example, there is an assessment of Bartholomew Boorne in the right area of the return [9]
<1704-1730+	Jos	Mercer	Given as the owner in the rental of 1704 [6,7]

DETAILS OF TENANCY

SOURCES marked [] at end of entry.

1. ESRO BAT 42, T.89 and 90.
2. SAC Vol. 52 p. 96.
3. ESRO AMS 1635.
4. ESRO XA3/4 1858, 3017, 3018. Battle court entries.
5. ESRO XA3/13 - rental of Iltonsbath, 1367.
6. ESRO HEH BA Vol. 23 (Rentals of 1595 and 1639) Vol 24 (Rental of 1652), Vol 25 (Rental of 1680) and Vol. 99 (Rental of 1704).
7. ESRO BAT 47 - Rental of 1730.
8. ESRO BAT 18.
9. ESRO XA5/2 - hearth tax return.
10. SRS Vol. 56 - Lay subside rolls 1524-1525.
11. ESRO BAT 40.

**SEDLSCOMBE - HOLMES HOUSE [P41/7]
NGR TQ7822 1790**

Originally part of a copyhold of Battle manor (Asselton House to the north) but late was separated and became a copyhold of the manor of Battle held at a quitrent of 6d.

DETAILS OF THE PROPERTY

<1639	NOT FORMED	Part of P41/19 in 1595 [3]
<1639-1724+	Ho + gdn	By 1639, and again in 1652 this and adjacent P41/16 was described as 2 messuages [3] Described as a messuage in 1704 [3] and shown on the 1724 manor map as a messuage and small garden (acreage illegible) [1]

DETAILS OF THE BUILDING

E15C	The building, which did not start life as a messuage, was surveyed by D and B Martin in 1978 and a archaeological report was made. It was briefly revisited in 2009 when building works were being undertaken to the rear wall. For the revised report see ESRO HBR 1/0350.
------	---

LAND TAX ASSESSMENTS

DETAILS OF OWNERSHIP

<1639	NOT FORMED	Part of P41/19 in 1595 [3]
<1639-1653	Agns Brigden, widow	She also owned P41/19, out of which this property was divided. [3] Her death was presented in 1653 [5]
<1704-1704+	John Clarke	[3]
<1707-1730+	Will Hyland	[1] Described as of Sedlescombe, mercer in 1707 [2,4]

DETAILS OF TENANCY

SOURCES marked [] at end of entry.

1. ESRO BAT 4421/9.
2. ESRO LHL Title deeds to a property in Hastings.
3. ESRO HEH BA Vol. 23 (Rentals of 1595 and 1639) Vol 24 (Rental of 1652), Vol 25 (Rental of 1680) and Vol. 99 (Rental of 1704).
4. ESRO BAT 47 - Rental of 1730.
5. ESRO BAT 18.

**SEDLSCOMBE - HOMESTALL HOUSE [P41/8]
NGR TQ 7818 1780**

Tenement of Bricklehurst manor called part of Bothurst.

DETAILS OF THE PROPERTY

<1543-1570+ Ho, gdn + 12a Described in 1543 as a parcel of Bothurst land being a messuage, garden and 12 acres of land in two parcels. Abuts:- E = highway Sedlescombe to Westfield; W = Eastons wood late Bothurst [P41/09]; S = Mill dyke belong to the mill called Abbey Mill. [1] Described in 1570 as a messuage, garden and 12 acres of land at Sedlescombe Street in Sedlescombe, occupied by John Baker [4]

DETAILS OF THE BUILDING

1738 The house was surveyed by D and B Martin in 1976 and a archaeological report was made. See ESRO HBR 1/0329.

LAND TAX ASSESSMENTS

DETAILS OF OWNERSHIP

<1543-1544+ Jas Firsby [1]
<1570-1570+ John Squire of Peasmarsh, weaver, in 1570 when he settled a moiety of the property on John Barnes of Jacobs and Roger Squire of Brede, in trust for John Squire's life, remainder to his daughter Amy Squire and her heirs in tail, remainder to his daughter Elizabeth Avan and her heirs in tail, remainder to his nephews John Squire and Richard Squire, sons of his brother Robert Squire [4]
<1609-1609+ Robt Weeks Of Brede in 1609, he paid a quitrent to Bricklehurst of 4/- [1]
<E18C Harmers His heirs held the property in the early 18th century [2]
<1843-1843+ Robt Weston [3]

DETAILS OF TENANCY

<1570-1570+ John Baker [4]
<1609-1609+ Bars Frencham Barscombe Frencham leased the property from Robert Weeks [1]

SOURCES marked [] at end of entry.

- 1. ESRO FRE 520 - ii.
- 2. Early 18th century map (copy in ROHAS archive as AMS 10).
- 3. ESRO TDE - Sedlescombe tithe award.
- 4. ESRO SAS/E 395 - settlement dated 3 Dec 1570
- 5. ESRO ACC 165/894-903



NOTES SUPPLIED BY C H C WHITTICK

ACC 165/894-903 = Deeds of a house, barn, shop and 12 acres at Sedlescombe (Harrison - Brightes, Bine and Barnsby - Ades), 1689-1737

Alas the shop is first mentioned in an agreement of 1737 but not in the following deed, so could have been there earlier

This may help and I will phone

Peter Harrison - Mary Harman - her executors (John Brightes, Edward Bine and William Barnsby and his wife Mary) - Thomas Ades of Sedlescombe pailmaker

final concord of 1737 also includes

1 house and acre in Sedlescombe Street occupied by the parish officers (E: Sedlescombe Street; W: late Peter Harrison; N: before Richard Shaw; S: Thomas and Ann Read); to Henry and Edward Snow

Mary Harman's will was witnessed by Francis Raines; John Raines of Sed cooper has an inventory of 1731 - PBT 1/10/2367 - which picks up the pailmaker perhaps

**SEDLESCOMBE - MANOR COTTAGES [P41/9]
NGR TQ 7807 1804**

Tenement of Bricklehurst manor. Part of a tenement called Bothurst.

DETAILS OF THE PROPERTY

<1543-1544+ Ho, gdn + land Described in 1543 as half of Bothurst tenement and a messuage, garden and 4 parcel being (c.8 acres). Abuts:- E = highway Sedlescombe to Westfield; W = lands of [] Ashburnham, esq called Ashburnhams; N = lands of Peter Easton and John Bachellers; S = lands of William Bothurst and Robert Waghorn [P41/28] [1].

DETAILS OF THE BUILDING

E15C The house was surveyed by D and B Martin in 1976 and a archaeological report was made. See ESRO HBR/1/0208.

'Barn' 17 or E18C Located at TQ 7807 1804 is a five bay building with southern lean-to. Incorporated within it is a two bay building of 17th or early 18th century date. It was not constructed as a barn, only becoming a barn when it was extended. It may have been used as a slaughter house or a building associated with a tannery. For a brief archeological report on the building see ESRO HBR 1/0451

LAND TAX ASSESSMENTS

DETAILS OF OWNERSHIP

<1543-1544+ Pet Easton [1]
E18C Elliot Shown on a map as being owned by Easton [2]

DETAILS OF TENANCY

<1543-1544+ Thos Colloway [1]
<1611-1611+ Will Dawes He held 12 acres of land in Sedlescombe Borough, Staple hundred [1] The porch has the initials WD and the date 1611 inscribed upon it.

SOURCES marked [] at end of entry.

1. ESRO FRE 520 - ii.
2. Map of early 18th century date (copy in ROHAS archives AMS 10).

SEDLSCOMBE - SPILSTEADS FARM [P41/10]

Copyhold tenement of Battle Manor held at a quitrent of 8/8d + freehold of the same manor called Luckwish held at a quitrent of 11/9d [M11/76 & 77] [1]. Also during mid-16th C a tenement of the same manor called Becke & Clove Oxe [M11/78].

DETAILS OF THE PROPERTY

<1569-1569+	Ho, Bn + 61½+ acres	Described in manorial survey of 1569 as a tenement (house), barn and 8 acres of copyhold land (q.r. 8/8d) + site of a house (burnt down) called Luckwish + 13½ acres of freehold land (q.r. 11/9d). Also 40 acres of land to the north of the lane. The abutments to all of these lands are given [1]. The southern abutment to the latter property is given as James Sluter's own land, making it clear that he also owned other land in addition to that held of Battle manor.
Mid/late-17th C	Ho, Bn + 21½+ acres	By the mid/late-17th C the 40 acres to the north of the lane had been amalgamated with Hancox Farm.
<1731-1843+	2 Hos, bldgs + 106a.	Already by 1731 the lands to the south of the property merged into this farm [4]. Described in the tithe award as a homestead (plot 376), house and garden (plot 377), another house and garden (plot 388) + 105a.3r.09p. being plots 376-397 [5].

DETAILS OF THE BUILDINGS

Surveyed See ESRO HBR 1/303

LAND TAX ASSESSMENTS - [4]

1731	£48	Described as 'late Frenchams'.
1735	£44	
1740	£41	
1745-1780	£37	
1785-1843	£45	

DETAILS OF OWNERSHIP

<1569-1569+	Jas	Slutter	[1].
<1700	Thos	Frencham, gent.	Gentleman/physician of Sedlescombe. He died holding the property [2].
<1717-1717	Sam	Frencham	Of Sedlescombe. Son of Thomas. He died holding the property in 1717. Probate inventory survives. Lists kitchen, parlour, milkhouse, little wash-house, closet, the butteries and bakehouse, brewhouse, kitchen chamber, parlour chamber, closet, milkhouse chamber, little chamber, and garret. Value of household contents = £104:10:00d, total inventory value £261:02:00d [3]. Samuel's heirs were given as the owners in 1724 [2].
<1731-1731+	Will	Duke	Owner occupier [4]
<1740-1755+	Mr	Boyes	[4]
<1780-1780+		Rogers, gent	[4]
<1785-1795+	Will	Boyes, gent	[4]
<1800-1800+	J	Boyes	[4]

<1805-1820+	Tild	Smith	Tild = Tilden [4].
<1841-1843+	Rich	Smith	Owner occupier [5].

DETAILS OF TENANCY

<1700	Thos	Frencham, gent	Owner occupier [2].
<1717-1717	Sam	Frencham	Owner occupier [2,3].
<1731-1731+	Will	Duke	Owner occupier [4]
<1735-1750+	Edw	Watson	[4]
<1755-1765+	S	Watson	[4]
<1770-1780+	F	Blundell	[4]
<1785-1800+	Step	Spilstead	[4]
<1805-1820+	Tild	Smith	Owner occupier of the land, but tenants in the house [4]
<1841-1843+	Rich	Smith	Owner occupier of the land, but tenants in the house [4,5].

SOURCES marked [] at end of entry. ESRO = East Sussex Record Office; SRS = Sussex Record Society;
HMAG = Hastings Museum and Art Gallery

1. ESRO BAT 42 - Survey of Battle manor.
2. ESRO BAT 4421.
3. ESRO W/Inv 877. Inventory of Samuel Frencham of Sedlescombe.
4. ESRO Sedlescombe land tax returns.
5. ESRO TDE 20. Award 1843, map 1841.

**SEDLSCOMBE - HARRIET HOUSE [P41/11]
NGR TQ 7821 1792**

Copyhold tenement of Battle manor held at a quitrent of 18d.

DETAILS OF THE PROPERTY

<1367-1433+	MERGED	In 1367 and 1433 this property had been merged into P41/19, though they were subsequently once more separated [3,8].
<1569-1569+	Ho, bn + 1a	Described in 1569 as a messuage, barn and 1 acre, quitrent 18d. Abuts:- N = messuage of the heirs of Lawrence Avanne [P41/35]; S = messuage of William Broke [P41/19] [1].
<1595-1704+	Ho + gdn	Described in the rentals as a messuage and garden [4]
<1724-1724+	Ho + 1a	By 1724 the barn had been destroyed [2] The property is shown on the 1724 map as a house + 0a.2r.29p [2].

DETAILS OF THE BUILDING

E/M16C	The house was surveyed by D and B Martin in 1978 and a archaeological report was made. See ESRO HBR 1/0347.
--------	---

LAND TAX ASSESSMENTS

DETAILS OF OWNERSHIP

<1367-1367+	MERGED	In 1367 this property had been merged into P41/19, though they were subsequently once more separated [3].
<1569	Bart Smith	His heirs held the property in 1569 [1]
<1595-1595+	John Brigden	[4] Also owned the adjacent P41/19.
<1639-1653	Agns Brigden, widow	[4] Also owned the adjacent P41/19. Widow of John Brigden, her death was presented in 1653 [6]
<1680-1704+	John Hucksteep, shoemaker	[4] ? this entry, according to the court book in 1653 John Manser was admitted [6]. The 1662/5 hearth tax return includes an entry of one flue for John Hucksteep, shoemaker, but this has not been confirmed as being this property [7]. The initials I M E and the date 1687 is on a weathervane on the property.
<1724-1730+	John Manser	[2,5]
>1724	Mr Graw	[2]

DETAILS OF TENANCY

SOURCES marked [] at end of entry.

1. ESRO BAT 42, T95.
2. ESRO BAT 4421/9.
3. ESRO XA3/13 - rental of Iltonsbath, 1367.
4. ESRO HEH BA Vol. 23 (Rentals of 1595 and 1639) Vol 24 (Rental of 1652), Vol 25 (Rental of 1680) and Vol. 99 (Rental of 1704).
5. ESRO BAT 47 - Rental of 1730.

6. ESRO BAT 18.
7. ESRO XA5/2 - hearth tax returns.
8. ESRO BAT 40.

**SEDLSCOMBE - BEECH HOUSE [P41/12]
NGR TQ7770 1869**

Freehold tenement of Crowhurst manor, qr 18d [M56/6]

DETAILS OF THE PROPERTY

<1584-1611+	Ho, bldgs + c84a	Described in Crowhurst manor documents in 1584 as a freehold house and 80 acres of land called Beech [6] Described in 1611 as a messuage, buildings and 14 pieces of land (84 acres) [2]
c1735	Ho, bldgs + c101a	Shown on a map of the property dating from c1735 as a house, barn, buildings and 101a.3r.22p called Beech. Fields shown, as are abutting owners [4]

DETAILS OF THE BUILDINGS

1662-1665 6 flues [3]

LAND TAX ASSESSMENTS [1]

1735-1775+	£43
<1799-1799	£47
1800-1843	£75

DETAILS OF OWNERSHIP

<1574-1574	John	Ashburnham esq	He died holding the property [6]
1574-1584	John	Ashburnham esq	Son and heir of John. Although he officially acquired the property in 1574, his mother?, Isobella retained a life interest and it was only after her death in 1584 that he sold it [6]
1584-1595	John	Brown	He bought the property in 1584 and formally acknowledge tenure in 1588 [6]. He sold it in 1595 [6]
1595-1595+	Walt	Everenden I	He purchased the property in 1595 [6]
<1611-1662+	John	Everenden I, gent	[2,3]
<1665-1678	Walt	Everenden II	[3] In 1667 he granted the property to his daughter, Jane, on her intended marriage to John Everenden of Lewes [4] and therefore from 1667 John Everenden II of Lewes held the property in the right of his wife [4] However, the Crowhurst manor records contradict this in that they note that Walter Everenden II (or was this yet another Walter?) acknowledged tenure of the property in 1670, stating that it was late his father's, John Everenden I, and that Walter II was also the occupier. Further, Walter's death was presented in the Crowhurst manor court in 1678 [6] He died in c1693 and the property descended to his daughter [4]
<1693-1693+	John	Everenden II	Depending upon who owned the property from 1667 until Walter's death in 1678, Jane and John Everenden did at some date acquire the property and they died holding it [4]
1693-1731	Sam	Plumber	[1,6] He held in the right of his wife, Martha, daughter of John Everenden of Lewes [4] Samuel made his will in 1726, proved 1731 [5]
1734-1740	John	Plumber gent	[1] In 1734 and the property was sold to his and Martha's only surviving son, John, for £1,365 [4] and the sale was recorded in the Crowhurst manor court in 1736 [6]. Perhaps this was to pay off a mortgage. He was declared bankrupt in 1740 and the property was sold [4]

1740-1740+	Phldia	Holmesby	[1]. Philadelphia was of Goudhurst when she acquired the property in 1740 [4]
<1765-1765+	Thos	Hussey	Given as owner in a Crowhurst manor rental dated 1765 [6]
<1775-1800+	Edw	Hussey	[1]
<1805-1843+	Mr	Hussey	[1]

DETAILS OF TENANCY

<1670-1670+	Walt	Everenden II	[6]
<1731-1731+	Mrs	Plumber	[1]
<1735-1740	John	Plumber, gent	[1]
<1745-1755+	John	Tassell	[1]
<1760-1760+	J	Chrisford	[1]
<1765-1765+	Mrs	Chrisford, widow +	
	Mrs	Holmesby	[1]
<1775-1800+	Will	Inskipp	[1]
<1805-1843+		Chrisford	[1]

SOURCES marked [] at end of entry.

1. ESRO ELT - Sedlescombe
2. ESRO FRE 520
3. ESRO XA5/2 - Hearth tax
4. Deeds in private hands
5. Lucy, B 'Twenty Centuries in Sedlescombe' p214.
6. ESRO RAF - Crowhurst mnor documents

**SEDLSCOMBE - STRAWBERRY HILL [P41/13]
NGR TQ 7959 2152**

Initially demesne of Robertsbridge manor called Belatkyns, Farmery Wood, Bechewood, Yerkeshill, and Primrose Garden, but subsequently converted to copyhold [M^/375-380]

DETAILS OF THE PROPERTY

<1567-1567+ Ho, kitch, bn + c106a Described (with abutments) in 1567 Robertsbridge manor survey as a messuage, kitchen, barn, 94 acres of pasture and 12a.2r woodland [2]

DETAILS OF THE BUILDINGS

Surveyed See ESRO HBR 1/344

LAND TAX ASSESSMENTS [1]

DETAILS OF OWNERSHIP

<1538-1567+ ROBERTSBRIDGE ABBEY ESTATE [2]
>1567 Will Stace He was granted these properties as copyhold, paying 4s.8d qr + 1 cock and 2 hens for Belatkyns, 16s.0d for Yerkshire and 2d for Primrose garden [2]
<1731-1731+ John Fuller, esq [1] Of Parkgate, Battle [2]
<1843-1843+ PFPF Ackland, bart PFPF = P. Palmer, Fuller, Palmer. He was of Parkgate in Battle [4]

DETAILS OF TENANCY

<1567 Rich Stace [2]
1566- Ralph Knight, gent He held by indenture dated 1566, but soon after the lease was made void and it was granted back out as copyhold of the earlier tenant's heirs [2]
<1632-1632+ Will Skinner He occupied a seat in Sedlescombe Church for this property [3]
<1843-1843+ Rich Smith [4]

SOURCES marked [] at end of entry.

1. ESRO ELT - Sedlescombe
2. SRS Vol 47, T375, 379, 380
3. SAC Vol 52, p.96
4. ESRO TDE 20 - Sedlescombe

**SEDLSCOMBE - POWDERMILLS [P41/14]
NGR TQ 7815 1768**

Originally a tenement of Battle manor, qr. 1s.0d., but already by 1433 merged into the demesne of Battle Manor

DETAILS OF THE PROPERTY

<1433	gdn	Described in 1433 (when already merged into the demesne) as a garden which had once been built upon. Abutments to property when owned by Adam Smith, prior to its merger: E = highway; W = Abbot's land. It used to pay 1/- rent. [4,5] From the date it was acquired by the abbey the holding was merged into the lands associated with Sedlescombe Mill to the west, which mill had been built by the abbey upon their acquisition of the land to the west of the garden in the early 13th century. The mill, which stood well back from the street, was rebuilt by them in 1471 [4].
<1433-1724+	Mill + land	[2,3] Described in Battle manor survey of 1569 survey as 'two mills under one roof' at which date it was held with eight acres called Whiteacres [4]
<1657-1724+	Ho, mill + c12a	By 1657 a mill house or tenement had been built to serve 'the water cornmill commonly called Tiltonbaths Mill' [4]. The message is again mentioned in 1707 when the mill and 12 acres were listed to Jospeh Lingham of Sedlescombe, miller [4]. At both dates the mill was said to be in the parishes of Battle and Sedlescombe.

DETAILS OF THE BUILDINGS

LAND TAX ASSESSMENTS [1]

DETAILS OF OWNERSHIP

<1433	Adam Smith	[4,5]
<1433-1724+	BATTLE ESTATE	[2,3,4,5]

DETAILS OF TENANCY

1471-1471+	Rich Sheppard	Richard Sheppard took a lease of the new mill in 1471
<1569-1569+	Robt Porter	He leased the mill, together with eight acres called Whiteacres [4,5]
1657-1657+	Steph Coleman, miller	Of Battle in 1657 [4]
<1707-1707+	Josph Lingham, miller	Of Sedlescombe [4]
<1724-1724+	Will Clarke	[3]

SOURCES marked [] at end of entry.

1. ESRO ELT - Sedlescombe
2. ESRO BAT4431
3. SAC Vol 52, p.96
4. B Lucy 'Twenty Centuries in Sedlescombe' (1978) pp. 94-95.
5. Searle, Battle Abbey and its Banlieu,

**SEDLSCOMBE - SACKVILLE COTTAGES [P41/15]
NGR TQ 7816 1786**

Tenement of Bricklehurst manor.

DETAILS OF THE PROPERTY

<1543-1544+ Ho + gdn

Described in 1543 as a messuage and garden. Abuts:- E = highway Sedlescombe to Westfield; W, S = lands of William Bothurst [P41/08]; N = lands of [] Waters widow. [1]

DETAILS OF THE BUILDING

E/M16C

The house was surveyed by D and B Martin in 1978 and a brief archaeological report was made. See ESRO HBR 1/0354.

LAND TAX ASSESSMENTS

DETAILS OF OWNERSHIP

<1543-1544+ Mrs Peny, widow

Given as owner on abutments to adjacent properties [1]

DETAILS OF TENANCY

<1543-1544+ Edw Daye

[1]

SOURCES marked [] at end of entry.

1. ESRO FRE 520 - ii.

**SEDLSCOMBE - FORGE COTTAGES [P41/16]
NGR TQ 7823 1788**

Copyhold of Battle manor held at a quitrent of 18d.

DETAILS OF THE PROPERTY

<1367-1367+	Smithy + gdn	Described in the rental of 1367 as a garden formerly William Smith, quitrent 2¼d x 4, + a smithy formerly William Smith, quitrent 4½d x 4 [3]
<1433-1433+	Ho + gdn	Described in survey of 1433 as a garden formerly William Skinner (quitrent 9d) and a messuage and curtilage formerly William Smith, quitrent 1/6d. Abuts to the garden:- N = John Nytherton [P41/19]; S = other property of this owner; E = Blackland. Abuts to the messuage and curtilage: S = John Bourner [P41/24]; N = other property of this owner; E = Blacklands [7].
<1569-1569+	Ho + 10a	Described in 1569 as a messuage and 1 acre, quitrent 18d. Abuts:- N = messuage of William Broke [P41/7]; S = garden in same ownership as this property; E = lands called Blacklands. Also a garden (½ acre), quitrent 9d. Abuts:- N = messuage described above; S = messuage of William Lawrence [P41/24]; E = Blacklands. Also freehold lands called Blacklands in Sedlescombe (9 acres) quitrent 4/4d. [1]
<1595-1639+	Ho + 1½a	Described in rentals as a messuage and 1 acre of land to it, quitrent 1/6d [4] + a garden of ½ acre quitrent 9d [4].
1646-1724+	Ho, shop + 1½a	In 1646 the court book records the grant of a small parcel of waste at Sedlescombe Street (their name for the settlement) on which William Hucksteep has lately erected part of a butchers shop, rent 4d [6]. From 1652 the shop held at a quitrent of 4d was added to the other entries in the rentals [4], it is not shown as a separate building on the 1724 map which suggests that the reference to ‘part of the butchers shop’ indicates it is the range which projects forward from the house. The 1724 map indicates the plot divided into two parcels, the front part being a house + 0a.2r.32p., and the back part a plot of land being 0a.3r.10p [2].

DETAILS OF THE BUILDING

Specialized building	Surveyed	The house now called Farthing Cottage [NGR TQ 7825 1782] was originally a specialized building and dates from the mid 18th century. It was surveyed by D and B Martin in 1978 and a archaeological report was made. See ESRO HBR 1/0348.
----------------------	----------	--

LAND TAX ASSESSMENTS

DETAILS OF OWNERSHIP

<1367	Will Smith	Given as the late owner in the 1367 rental [3].
<1367-1367+	Rich Smith	Given as the owner in the 1367 rental [3].
<1433-1433+	John Baker	[7]
<1569-1569+	Rofes + Bart Garraway	They held in the right of their wives [1] By 1582

<1639-1639+	Mr	Bishop	Bartholomew Garraway had become sole owner and in that year he was granted licence to let the property for 5 years.
<1652	Will	Huckstep	He was still owner in 1595 [4]
<1704-1730+	Will	Huckstep	[4] His heirs are given as the owner in 1652 and 1680 [4]
			[2] Given as owner in 1704 [4,5]

DETAILS OF TENANCY

SOURCES marked [] at end of entry.

1. ESRO BAT 42, T.97.
2. ESRO BAT 4421/9.
3. ESRO XA3/13 - rental of Iltons bath, 1367.
4. ESRO HEH BA Vol. 23 (Rentals of 1595 and 1639) Vol 24 (Rental of 1652), Vol 25 (Rental of 1680) and Vol. 99 (Rental of 1704).
5. ESRO BAT 47 - Rental of 1730.
6. ESRO BAT 18.
7. ESRO BAT 40.

**SEDLSCOMBE - ROSEHILL COTTAGE [P41/17]
NGR TQ 7802 1828**

DETAILS OF THE PROPERTY

DETAILS OF THE BUILDING

DESTROYED

LAND TAX ASSESSMENTS [1]

DETAILS OF OWNERSHIP

DETAILS OF TENANCY

SOURCES marked [] at end of entry.

1. ESRO ELT - Sedlescombe

**SEDLSCOMBE - COACH AND HORSES [P41/18]
NGR TQ 7827 1778**

Copyhold of Battle manor, quitrent 1/6d.

DETAILS OF THE PROPERTY

<1367-1367+	Ho	Described in a rental of 1367 as a messuage formerly John a Wyck, quitrent [] [4]
<1433-1433+	Ho + curt	Described in 1433 as a messuage and curtilage. Abuts John Bourner South; [John Bourner North (the survey gives Thomas Harry as the north abutment, but this does not work with the other entries and is contrary to the abutments given in a court entry of 1430 which gives the north and south abutments to this property as John Bourner, which does work with the other 1433 entries [3])], Blacklands East, quitrent 1/6d. [2]
<1524-1524+	Ho + curtilage	Described in court entry as a bondhold messuage and curtilage at Iltonsbath, in Sedlescombe [3].
<1569-1730+	Ho + 1a.	Described in 1569 as a house and 1 acre, quitrent 18d. Abuts:- N = messuage of William Lawrence [P41/24]; S = messuage of John Philpot [P41/29]; E = Blacklands [1] Shown on the 1724 manor map as a house (irregular in plan) + 1a.0r.00p. [7]

DETAILS OF THE BUILDING

1662-1665	2 flues	House assessed at 2 flues in the hearth tax returns [9]. Destroyed by fire.
-----------	---------	--

LAND TAX ASSESSMENTS

DETAILS OF OWNERSHIP

<1367-1367+	Rich	Smith	Given as the owner in survey of 1367 [4] Given as a late owner in survey of 1433 [2]
<1418	Maud	Smith	Given as a previous owner in a court entry of 1418 [3].
<1409	Hen	Stock	[3]
<1418	Flo	Stock	Given as a late owner in court entry of 1418 [3].
<1409-1410	Alce	Harry	Daughter of William Motkin, took on surrender of Richard Smith, senior and heir of William Smith of Iltonsbath, once Henry Stock and wife [3]
<1418-1428	Alce	Palmer	In 1418 William Palmer and his wife Alice did fealty for the third part of a tenement in Iltonsbath, late Florence Stock, whereof Maud Smith lately died seised [3]. The following year Robert Harry conveyed his interest in the property to the said William Palmer and his wife Alice, and in 1421 William Palmer was granted licence to demolish a building from the tenement and undertook to pay the rent of 18d that it used to pay, and if sufficeint distress cannot be found on the tenement then it may be found on the messuage and tenement of Richard Smith [in 1367 Smith is known to have held more than one property in the settlement] [3]. Given as the wife of William Palmer formerly Alice Harry. Her death was presented in 1427/8 and her husband had a life interest in the property, after which it descends to her son [3]

<1433-1472	Thos	Harry	He inherited from his mother Alice Palmer [2,3]
1472-1499	Rich	Harry	Son of Thomas Harry [3]. He alienates the property in 1499 but retained a life interest [3]
1499-1499+	Thos	Archer	[3]
<1504	Will	Cutler	Described as late of Sedlescombe in 1504 [3]
1504-1504+	John	Cutler	Brother and heir of William Cutler. He was about to die and surrendered to his mother, Helen Upon (late wife of Thomas Cutler als Archer). she surrendered to William Peny [3]
1504-1524	Will	Peny	An entry in the Marley court rolls made 12 July 1522 notes that William Peny, not otherwise known in the country but as a free man [and] who acquired 4a of meadow in Sedlescombe held of this manor [of Marley] in villeinage; now it is revealed that he was raised in villeinage and is a nief of the heirs of Lord Fehew as of his manor of Frome Quinton in Dorset and known from birth as William Boyle - the bailiff ordered to seise the 4 acres [8]. In 1524, when his death was presented, he is given as William Peny als Boil, heriot a mare. His heirs were his daughters, Joan (wife of William Bishop) and Juliana (wife of Thomas Philpot) [3]
1524-1560	heirs of Peny		On William Peny's death he left a widow, Elizabeth, who inherited P41/29 and was assessed in the 1524 lay subsidy returns at £6 [10]. With regards to this property, the heirs of William Peny were deemed to be his daughters, Joan (wife of William Bishop) and Juliana (wife of Thomas Philpot), who were admitted to their respective halves in 1524. In 1549 Joan and her husband, William Bishop, surrendered their half interest to Richard Johnson. By 1560 the other half had somehow been acquired by Henry Whiterfield, whose share was inherited by his son, John Whitefield, who in that year convey.ed his interest to Richard Johnson, thereby re-uniting the property under a single owner [3].
1560-1565	Rich	Johnson	He had acquired a part interest in 1549 and the other part in 1560. His heirs held the property in 1569 [1,3]
1565-1565+	Rich	Johnson	Son of Richard, he was a minor at his fathers death [3]
<1595	Will	Green	His heirs held the property in 1595 [5]
<1609-1609	Elen	Bulbeck	Elenor, wife of John Bulbeck, held the property as daughter and heir of [] Green. She sold the property in 1609. By 1615, when she confirmed the sale, she was Elenor Wilson, widow [5].
1609-1615+	Rich	Dale	[5]
<1639-1639+	Will	Leeds	[5]
<1652-1680+	Rich	Carpenter, glover	[5] He was assessed in the hearth tax returns at 2 flues [9]
<1704-1724+	Will	Carpenter	[5,7]
<1730-1730+	Ann	Atree	[6]

DETAILS OF TENANCY

<1662-1665+ Rich Carpenter, glover Owner occupier [9]

SOURCES marked [] at end of entry.

1. ESRO BAT 42, T. 100.
2. ESRO BAT - Battle 1433 manorial survey.
3. ESRO XA3/4, 1323, 1335, 1363, 1477, 2623, 2626-2627, 3080, 3150, 3478-3479. Battle court records
4. ESRO XA3/13 - survey of 1367.
5. ESRO HEH BA Vol. 23 (Rentals of 1595 and 1639) Vol 24 (Rental of 1652), Vol 25 (Rental of 1680) and Vol. 99 (Rental of 1704).
6. ESRO BAT 47 - Rental of 1730.
7. ESRO 4421/9.

8. ESRO XA3/11 - marley court rolls.
9. ESRO XA5/2 - hearth tax returns
10. SRS Vol. 56 - Lay subsidy rolls 1524-1525.

**SEDLSCOMBE - ASSELTON HOUSE [P41/19]
NGR TQ 7823 1791**

Copyhold of Battle manor, quitrent 18d. From before 1367 until after 1433 this and adjacent P41/35 were combined with a quitrent of 3/-, but by 1569 the two had been separated and the quitrent apportioned to 1/6d each, reinstating the original quitrent. Later this part was itself split, 1/- for this property and 6d for P41/07.

DETAILS OF THE PROPERTY

<1367-1433+	Ho	Described in 1367 as a messuage formerly Robert Bourner, quitrent 9d x 4 (ie. 2 tenements combined) [4]. Described in 1433 survey as a messuage and curtilage formerly Robert Bourner, quitrent 3/- [ie. two tenements combined]. Abuts:- S = John Baker [P41/16]; N = Thomas Harry [P41/35]; E = Blacklands. [9]
<1540-1562+	Ho + Gdn	Described in court entries of 1540 and 1562 as a messuage and garden in Iltonsbath [3]
<1560-1569+	Ho + 1a.	Described in the court book in 1559 and 1560 as a messuage and garden adjoining in Iltonsbath [3] Described in the manorial survey of 1569 as a copyhold messuage with one acre in the parish of Sedlescombe. North = messuage of the heirs of Bartholomew Smith [P41/1]; south = messuage of blank Rofes and Bartholomew Garrantay [P41/16]; east = lands called Blacklands. Quitrent 18d. [1]
<1653-1653	Ho + land	By 1653 a piece of land called Collywish had been transferred to this property, from P41/36. In 1653 Collywish was sold and became attached to P41/29 [7]
1653-1730+	Ho	[7] Shown on the 1724 manor map as a house (set back from the road) + 0a.2r.02p [2].

DETAILS OF THE BUILDING

M15C

The house was surveyed by D and B Martin in 1978 and a archaeological report was made. See ESRO HBR 1/0312.

LAND TAX ASSESSMENTS [1]

DETAILS OF OWNERSHIP

<1367	Robt	Bourner	His is given as a late owner in the 1367 rental [4].
<1367-1367+	John	Nytherton	He is given as the owner in the 1367 rental [4]
<1433-1433+	John	Nytherton	[9]
<1510	Alan	Daniel	In total within Iltonsbath Alan held a copyhold messuage and curtilage [this property]; moeity of a copyhold messuage and croft called Martins Town [part P41/03]; a copyhold cottage and garden late in the lords hands [part P41/03] and a croft called Wedytts Croft [3]. He was dead by 1510 [3]
1510-1520	John	Daniel	Son of Alan Daniel [3]. He surrendered the copyhold cottage and garden (this property) to Simon Stalker and his wife in 1520 [3]
1520-1540	Sim	Stalker	He held with his wife [3]. Simon was assessed in the 1524 lay subsidy return at £15 [8] His death was presented in 1540, leaving the property to his wife Elizabeth for life if

1559-1559	Phil	Stalker	she stays single; if not, it should descend according to Simon's will [3]. Son of Simon [3]. He surrendered to Marion Hopton in 1559 [3]
1559-1560	Mar	Hopton	Marion surrendered the property to Bartholomew Abroke [3]
1560-1562	Bart	Broke als Abroke	He died holding the property [3]
1562-1569+	Will	Broke	Son of Bartholomew, he was 14 in 1562 [3]. He held the property in 1569 [1]
<1595	John	Brigden	[5] Also owned the adjacent P41/11.
<1639-1653	Agns	Brigden, widow	[5] Also owned the adjacent P41/11. Furthermore, by 1639 an ancillary building upon this building had been converted into a house, for which see P41/07. Widow of John, her death was presented in 1653 [7]
<1704-1704+	Isaac	Cruttenden	[5]
<1724-1730+	Mrs	Cane, widow	[2,6]

DETAILS OF TENANCY

SOURCES marked [] at end of entry.

1. ESRO BAT 42, T96
2. ESRO BAT 4421/9.
3. ESRO XA3/4, 3003, 3428, 3436, 3471, 3549. Court records.
4. ESRO XA3/13 - rental of Iltonsbath, 1367.
5. ESRO HEH BA Vol. 23 (Rentals of 1595 and 1639) Vol 24 (Rental of 1652), Vol 25 (Rental of 1680) and Vol. 99 (Rental of 1704).
6. ESRO BAT 47 - Rental of 1730.
7. ESRO BAT 18.
8. SRS Vol. 56 - Lay subside rolls 1524-1525.
9. ESRO BAT 40.

**SEDLSCOMBE - LITTLE HANCOX [P41/20]
NGR TQ 7725 1891**

Freehold of Battle manor, qr 20d.

DETAILS OF THE PROPERTY

<1444-1569+ Cot + c1a

Described in a grant by the lord of the manor in 1444 as a croft (1 acre) in Whatlington <Sedlescombe> upon which to build a house. Abuts: E = Durhamford Stream, S = highway [4]
Described in Battle manor survey of 1569 as a cottage, garden + 0a.2r. [2]

DETAILS OF THE BUILDINGS

LAND TAX ASSESSMENTS [1]

DETAILS OF OWNERSHIP

1444-1444+ John Castleman
<1569-1569+ John Bishop
<1676-1676+ Will Brightes
<1724-1724+ John Brightes

He and hiswife Joan were granted the property in 1444 [4]
[2]
[3]
[2]

DETAILS OF TENANCY

SOURCES marked [] at end of entry.

1. ESRO ELT - Sedlescombe
2. ESRO BAT 42, T80
3. CKS U269 T127
4. ESRO XA3/4 1668

**SEDLESCOMBE - OLD THATCH [P41/21]
NGR TQ 7821 1777**

Tenement of Bricklehurst manor.

DETAILS OF THE PROPERTY

<1543-1544+ Ho + 1a.

Described in 1543/4 as a messuage and garden (1a) lieth east to the highway (Sedlescombe Street), west to William Bothurst land, north to the land of John Hammond, south to the Mill Way [1].

DETAILS OF THE BUILDING

15C

The house was surveyed by D and B Martin in 1978 and a archaeological report was made. See ESRO HBR/1/0324. It was revisited after fire damage and additional notes made.

LAND TAX ASSESSMENTS [1]

DETAILS OF OWNERSHIP

<1543 Shephard
<1543-1544+ Thos Rodes

Given as a late owner [1]
He held in the right of his wife [1]

DETAILS OF TENANCY

<1543-1544+ John Nevile

[1]

SOURCES marked [] at end of entry.

1. ESRO FRE 520 - ii.

**SEDLSCOMBE - OLD GUN HOUSE [P41/22]
NGR TQ 7806 1817**

DETAILS OF THE PROPERTY

DETAILS OF THE BUILDINGS

LAND TAX ASSESSMENTS [1]

DETAILS OF OWNERSHIP

DETAILS OF TENANCY

SOURCES marked [] at end of entry.

1. ESRO ELT - Sedlescombe

**SEDLSCOMBE - DURUD [P41/23]
NGR TQ 7814 1794**

Tenement of Bricklehurst manor.

DETAILS OF THE PROPERTY

<1543-1544+ Ho + 1a.

Described in 1543-4 as a messuage and garden (c.1 acre).
Abuts:- E = highway Sedlescombe to Westfield; W = lands
of Peter Easton [P41/09]; N = lands of Robert Waghorn
[P41/28]; S = lands of Thomas Waters [P41/30]. [1]

DETAILS OF THE BUILDING

M16-17C

The house was surveyed by D and B Martin in 1978 and a
brief archaeological report was made. See ESRO
HBR 1/0338.

LAND TAX ASSESSMENTS [1]

DETAILS OF OWNERSHIP

<1543-1544+ Thos Vanns
<1843-1843+ Thos Byner

[1]
Owner occupier [2]

DETAILS OF TENANCY

<1543-1544+ Jas Gibbin
<1843-1843+ Thos Byner

[1]
[2]

SOURCES marked [] at end of entry.

1. ESRO FRE 520 - ii.
2. ESRO TDE - Sedlescombe tithe award

**SEDLSCOMBE - ILTONSBETH & BARRACK COTTAGE [P41/24]
NGR TQ 7826 1780**

Copyhold of Battle manor held at a quitrent of 18d.

DETAILS OF THE PROPERTY

<1367-1367+	Ho	Described in the 1367 rental as a messuage late William Watman, quitrent 4½d x 4 [4].
<1433-1433+	Gdn	Described in 1433 as a garden built upon, once Mabel Smith. Abuts: S = Thomas Harry [P41/18]; N = John Baker [P41/16]; E = Blacklands, quitrent 1/6d [3, 7].
<1560-1560+	Ho, kit + gdn	Described in court entry of 1560 as a freehold messuage, curtilage, kitchen and garden in Sedlescombe at Iltonsbath [3]. It is unclear as why the court entry refers to this as a freehold, whereas the survey of 1569 refers to it as a copyhold. The same owner held a bondhold called Freeland Brook (½ acre). [3]
<1569-1569+	Ho + 1a + 4a.	Described in 1569 as a messuage and 1 acre. He also held by copy 3 parcels of brookland called Freelands Brook (4a) in the parish of Sedlescombe. Abuts:- S = Lords land called North Bathurst; E = freehold lands of said William [Lawrence]; N, W = lands called Millmede in the tenure of John Philpott [1].
<1595-1724+	Ho + 1a	Described in the rentals of 1595 to 1704 as a messuage and 1 acre, quitrent 1/6d [5] Shown on the 1724 manor map as a messuage, building at the rear + 1a.0r.28p [2]

DETAILS OF THE BUILDING

15C

The house was surveyed by D and B Martin in 1978 and a archaeological report was made. See ESRO HBR 1/0325.

LAND TAX ASSESSMENTS

DETAILS OF OWNERSHIP

<1367	Will	Watman	Given as the late owner in 1367 [4]
<1367-1367+	Mabel	Smith	Given as the owner in 1367 [4]. Given as a late owner in 1433 [3]
<1433-1433+	John	Bourner	[3,7]
<1560-1560	Will	Lawrence	His death was presented in 1560 (heriot a cow). His heir was given as his son, William Lawrence by will [3]
<1569-1595+	Will	Lawrence	Son of William. He held the property in 1569 [1,5]
<1639	Alan	Gibbon	His heirs held the property in 1639 [5]
<1652		Foster	His heirs held the property in 1652 [5]
<1680-1680+	Dan	Sole	Daniel held the property in 1680 [5]
<1704-1724+	Will	Boarman	[2, 5]
<1730-1730+	John	Boarman	[6]

DETAILS OF TENANCY

SOURCES marked [] at end of entry.

1. ESRO BAT 42, T99.
2. ESRO BAT 4421/9.
3. ESRO XA3/4 Battle court records, 3462-3463.
4. ESRO XA3/13. Survey of 1367.
5. ESRO HEH BA Vol. 23 (Rentals of 1595 and 1639) Vol 24 (Rental of 1652), Vol 25 (Rental of 1680) and Vol. 99 (Rental of 1704).
6. ESRO BAT 47 - Rental of 1730.
7. ESRO BAT 40.

SEDLSCOMBE - LITTLE CASTLEMANS [P41/25]

DETAILS OF THE PROPERTY

<1758-1758+ Ho, Bldgs + c219a

Map of Castlemans Farm shows the house now called Little Castlemans + adjacent barn, + barn, forstall and buildings (but no house) where Castlemans Farmhouse now stands to the south of the church + 218a.2r.32p [2].

DETAILS OF THE BUILDINGS

LAND TAX ASSESSMENTS [1]

1731	£30
1735	£47
1740	£45
1745	£46
1750	£48
1751	£71
1755-1780	£75
1785-1835	£100
1843	£102.

DETAILS OF OWNERSHIP

<1731-1731+	Mr	Tomlin	[1]
<1751-1795+	Jos	Calverly, esq.	[1,2]
<1800-1820+	Will	Mason, gent.	[1]
<1825-1843+		Woodward	[1]

DETAILS OF TENANCY

<1731-1750+	John	Russell	[1]
<1755-1765+	Isac	Baker	[1]
<1770-1780+	J	Baker	[1]

SOURCES marked [] at end of entry.

1. ESRO Sedlescombe Land Tax.
2. ESRO SAS/Acc 1137.

**SEDLSCOMBE - SWALES GREEN [P41/26]
NGR TQ 7710 2106**

The called 'Vyles and Upathomes', comprised a copyhold tenement of the manor of Robertsbridge, qr 6s.

DETAILS OF THE PROPERTY

<1567-1567+	Ho, bn + 12a	Described in 1567 as a messuage, garden and one croft (2 acres) called Vyles on the north of the present day B2089, whilst the barn and four closes (10 acres including 1 acre of wood) called Upathomes were situated opposite on the south side [1].
<1727-1753+	Ho(s), bldgs+ c62a	By 1727 this property and the adjacent Cripses Farm had been merged [2]. Cripses Farm was made up of five Robertsbridge manorial tenements and comprised a house, garden, barn and 50¼ acres held at a total quitrent of 9s.5d [3]. Shown on a map dated 1753 as a house, barn, buildings + 65a.1r.24p 'near Swales Green'. Abutting owners shown [10]
<1843-1843+	Ho, bldgs + c126a	By the 1840s the property was called Swales Green Farm and comprised both Vyles and Cripses. It then comprised 71½ acres of plainland and 55 acres of woodland [11]. The additional 64 acres over and above the earlier figures quoted comprised lands called Badlands, which in 1567 had been demesne of Robertsbridge manor. It is not known when the Robertsbridge demesne lands were purchased, though the assessments in the Ewhurst poor book suggest that the purchase may have occurred prior to 1726.

DETAILS OF THE BUILDINGS

HOUSE

Surveyed See ESRO HBR 1/750

BARN

Surveyed See ESRO HBR 1/541

LAND TAX ASSESSMENTS [8]

DETAILS OF OWNERSHIP

<1526-1526	John Motyes	[1]
1526-1534	John Derby	He held by copy dated 4 October 1526 [1]
1534-1547	John Simson	He held by copy dated 9 April 1534 [1]
1547-1567+	John Symson	He held by copy dated 23 June 1547 [1]
<1609-1609+	Nich Bewnt	[1]
<1638-1638+	Henry Barnes I	[1]
<1711-1725	Henry Barnes II	[2] Described as 'of Hooe' in 1711 when he made his will leaving all his land in Ewhurst and Sedlescombe to his eldest son, Henry [9]. His will was proved in 1725 [9]
1725-1725+	Henry Barnes III	

<1814	John	Shoesmith	[5]
<1814	John	Holman	[6]
<1814-1814	Rich	Mercer, gent	[6]. In his will dated 1814 Richard Mercer is styled as 'of Swales Green, gent' [7]
<1843-1843+	VINEHALL	ESTATE	[11]

DETAILS OF TENANCY

<1726-1726+	Thos	Creacy	An outdweller in respect of Sedlescombe [8]
<1814-1814	Rich	Mercer, gent	Styled as 'of Swales Green, gent' in his will made in 1814 [7].
1814-1814+	Rich	Mercer, jnr, farmer	Styled as 'of Swales Green in Sedlescombe, farmer' [7]

SOURCES marked [] at end of entry.

1. SRS Vol. 47 tenement 151.
2. ESRO SHE 2/20 & 6/24.
3. SRS Vol. 47 Tenements 144, 145, 148, 149 and 151.
4. SRS Vol. 47 Tenement 155.
5. ESRO SHE 2/20.
6. SRS Vol. 47 Tenement 151 updates.
7. B Lucy 'Twenty Centuries in Sedlescombe' (1978) p. 240. The earlier history given in this book appears to be incorrect, part probably relating to adjacent Swales Farm, and the remainder to other Sedlescombe properties.
8. ESRO ELT - Sedlescombe
9. ESRO AMS 1433
10. ESRO SAS/ACC 801 - map of the farm dated 1753
11. ESRO TDE 20 - Sedlescombe

**SEDLSCOMBE - GREGORYS OLD BAKERY [P41/27]
NGR TQ 7821 1779**

Tenement of Bricklehurst manor

DETAILS OF THE PROPERTY

<1543-1544+ Ho + gdn

Described in 1543/4 as a messuage and garden. Abutments:-
E = highway Sedlescombe to Westfield; W, N = Borhurst
land; S = lands of Thomas Roads, wife. [1]

DETAILS OF THE BUILDING

M17C

The house was surveyed by D and B Martin in 1984 and
revisited in 1985. An archaeological report was made for
which See ESRO HBR 1/0891 revised.

LAND TAX ASSESSMENTS

DETAILS OF OWNERSHIP

<1543-1544+ John Hammond [1]

DETAILS OF TENANCY

<1543-1544+ John Dawes [1]

SOURCES marked [] at end of entry.

1. ESRO FRE 520 - ii.

**SEDLSCOMBE - CHESTNUT TREE [P41/28]
NGR TQ 78102 17989**

Tenement of Bricklehurst manor, quitrent 8d.

DETAILS OF THE PROPERTY

<1543-1543+ Ho + ½a.

Described in a manorial survey of 1543 as a messuage and garden (c.½a). Abuts:- E = highway Sedlescombe to Westfield; W, N = lands of Peter Easton [P41/09]; S = lands of Thomas Vanns [P41/23]. [1]

DETAILS OF THE BUILDING

Surveyed

See ESRO HBR 1/1789

LAND TAX ASSESSMENTS

DETAILS OF OWNERSHIP

<1543-1543+ Robt Waghorn
<1609-1611+ Joana Avann, widow

[1]
Joanna [1]. A 1611 Sedlescombe borough tax list records that Widow Vann held one acre within the Borough [1]

DETAILS OF TENANCY

<1543-1543+ Rich Marks

[1]

SOURCES marked [] at end of entry.

1. ESRO FRE 520 (ii).

SEDLSCOMBE - TANYARD HOUSE AND STORES
[P41/29]
NGR TQ 78270 17770

Copyhold tenement of Battle manor held at an annual quitrent of 1/6d. [Also from 1653 a copyhold called Collywish (4 acres) held at a quitrent of 3/1d.]

DETAILS OF THE PROPERTY

<1367-1367+	Ho	Described in the 1367 rental as Thomas Gylow for his own messuage, quitrent 4½d x 4 [19].
1433-1653	Mess + Gdn	Described in the Battle manorial survey of 1433 as a messuage and curtilage. Abuts: South = the land of John Bothurst (Collywish), North = land of Thomas Harry, East = lands called Blackland. Quitrent 1/6d [15]. Described in a surrender of 1455 as a cottage and garden adjoining (1a) at Iltons bath, late Thomas Gylow's [1]. Described in a court entry of 1546 as a messuage, curtilage and garden at Iltons bath [1].
<1569-1576+	Mess, gdn + 3a	Described in a manorial survey of 1569 as a copyhold messuage with one acre of land in the parish of Sedlescombe between the messuage of the heirs of Richard Johnson north, a meadow called Collywish south, and lands called Blacklands east. Quitrent 1/6d. Also at this date a meadow called Millmeade containing by estimation 3 acres on the west of the mill in the parish of Sedlescombe was owned with this property bounded by The Mill Pond north, to land of the manor of Marley and to Freeland Brook south and east, and to an old watercourse running from Freelands Brook, east. Quitrent 2/1d [16].
1653-1736+	Mess, gdn + 4a.	Same description in a sale dated 1575 [1] Messuage and garden (1/6d) + c. 4 acres of meadow called Collywish (3/1d). Collywish had been sold off from P41/19 in 1653 and merged into this property [2]
.<1649-1653	Mess, gdn (1a)	Described in 1649 as a messuage and 1 acre in Sedlescombe [2].
1653-1736+	Mess + 5a.	In 1653 the owner of this property purchased a 4 acre meadow called 'Collywish' adjacent to the house and garden [2] and in 1659 he surrendered the entire property to the use of his will [2]. Map of Battle manor shows the house with an outbuilding to the south (on the site of the present day 'tithe barn') and another to the rear. The total acreage (including Collywish) is given as 5a.2r.35p. (being the house plot of 1a.0r.10p. + the front part of Collywish at 1a.1r.02p., and a back part of Collywish being 3a.1r.23p.) [17]

DETAILS OF THE BUILDINGS

1485	House rebuilt	The property was granted out (after being forfeited for non repair) on the condition that the messuage be rebuilt within the term [1]. House survives in part - for details see ESRO HBR/1/950.
M 17C c.1630	Crosswing added to house. Tannery by this date	for details see ESRO HBR 1/950. From c1630 the property was occupied as a tannery, thus its present name.
1662	assessed 5 flues, but 4	House assessed in hearth tax returns as 'five flues but 4'.

LAND TAX ASSESSMENTS []

DETAILS OF OWNERSHIP

<1367-1367+	Thos	Gylow	Given as the owner in the rental of 1367 [19].
<1418-1420	Thos	Gylow	He held with his wife. In 1418 Thomas Gylow surrendered this property to his wife Margaret and her heirs [1]. By 1420 she was dead and it descended to her brother and heir, Richard Knight, who in the same year conveyed it to William Fogelot als Jacopp and his wife Alice [1].
1420-1425	Will	Jacopp als Fowelott	He held with his wife Alice from 1420. They conveyed the property in 1425 to Thomas Reynolds, vicar of Westfield [1].
1425-1427	Thos	Reynolds, vicar	Vicar of Westfield. He acquired the property in 1425 and conveyed it in 1427 to William Palmer and wife Alice [1].
1427-1429	Will	Palmer	He held with his wife Alice by conveyance dated 1427. In 1429 they conveyed to John Bourner [1].
1429-1435	John	Bourner	He acquired the property in 1429 [1] and given as owner in the Battle manorial survey of 1433, in which it was described as once Thomas Gylow's [15]. He held the property until his death in 1435 when it was inherited by his brother [1].
1435-1435+	Robt	Bourner	Brother of John [1].
<1455-1455	Thos	Hammond	He held with his wife Margaret. They surrendered the property to Thomas Frenshe and his wife in 1455 [1].
1455-1484	Thos	Frenshe	He held with his wife Alice.
1484-1485		In hand	In the lords hands through default of repairs. In January 1485 it was re-granted [1].
1485-1487	Rich	Knollys	He held with his wife Margery, daughter of Thomas Frenshe by new grant from the lord dated January 1485 upon condition that the messuage was rebuilt within a term upon pain of forfeiture [1]. In November 1487 they conveyed the property to Thomas Cutler (no heriot, no animal) [1].
1487-1501	Thos	Cutler	He acquired the property in 1487 [1]. In 1501, when about to die, he surrendered the property to the use of his last will.
1501-1504	Thos	Cutler, heirs of	Thomas Cutler's heir was his son, William, who by 1504 was himself dead, for in that year the property was in the ownership of John, brother and heir of William Cutler of Sedlescombe, deceased [1]. At this date John was also about to die and he left the holding to his mother, Helen (no heriot, no animal) [1]. Helen Upton, widow of Thomas Cutler, was admitted on 24th September 1504 and she, together with her husband John Upton at the same court surrendered to William Penny (heriot 5/- + 2 capons) [1].
1504-1524	Will	Penny	He held with his wife Elizabeth. He acquired the property in 1504. John Colnet, to whom the property had apparently been 'granted' in 1501 had surrendered his interest in the property to the said William Penny and his wife Elizabeth on 5th March 1504 [1]. William died in 1524, leaving his wife Elizabeth as his heir.
1524-1546	Eliz	Peny, widow	Elizabeth Penny was assessed in lay subsidy return at £6 [22] continued to hold the property until her death in 1546, though by 1546 [1] when it was inherited by John Phylpot, her grandson [1].
1546-1575	John	Phylpot	He inherited the property in 1546 as son of Thomas Phylpot and his wife Julian, the daughter of Elizabeth Penny. John was at this date aged 7. Note - Two pieces of brookland at

			Iltonsbath which were also owned by said Elizabeth were inherited by John Bishop, youngest son of William Bishop and his wife Joan, another daughter and heir of Elizabeth Penny. John Phylpot was formerly admitted to his inheritance on 19th September 1552 and on 1st October 1560 he was granted a licence to lease the property to John Amyott for 16 years [1]. He sold the property to his tenant in 1575 [1].
1575-1595+	John	Amyott	Tenant since 1560, in 1575 he purchased the property from his landlord, John Philpot [1, 20].
<1620-1627	Rich	Dale, butcher	Of Sedlescombe, owner occupier. In a deposition made on 5th December 1620 Richard Dale is described as 'of Sedlescombe, butcher'. He was then aged 55 years. He was born in Lymington, Hampshire, and had lived in Sedlescombe for about 30 years. He was literate [10]. In a Sedlescombe parish tax of 4d in the pound taken in c.1620 Richard was assessed 20s for his own lands, £3.10s.0d for farmlands and 10d. for wealth [11]. He died in 1627 leaving a wife, Ann, sons John and Robert and a sister, Elizabeth Pook [12]. His wife, Ann, died in 1631 [13] and the property was inherited by their son, Robert. Robert lived at Brede and thus did not occupy the house.
c1627-1638	Robt	Dale	[20] Of Brede. He died in 1645 (death presented at court 19/10/1646). In his will made in 1638 he is described as 'of Brede, butcher'. He had a daughter, Elizabeth, and an aunt, Elizabeth Pook. His will describes a 'house and land where I live in Brede with the outhouses' which he left to his wife, Matha, with remainder to daughter, Elizabeth [2,3]. No reference is made to the house in Sedlescombe, but the 1645 court entry shows that it too was inherited by Elizabeth, by this time the wife of Robert Foster [2].
1638-1649	Robt	Foster	[20] He held with his wife Elizabeth, daughter of Robert Dale [2]. In 1649 Elizabeth and Robert conveyed the 'messuage and 1 acre in Sedlescombe' to George Biggs, tanner. [2].
1649-1681	Geo	Bigge, senior, tanner	[20] Of Sedlescombe. He had probably been tenant since the early 1630s. He purchased Collywish in 1653. In 1662, described as 'tanner' he was assessed for this property at 5 flues, but 4 according to an added note [18]. George took out a mortgage of the property with Thomas Smith, yeoman, in 1680, the sum being £157.5s.0d [4]. Earlier, in 1678, George (at that date describing himself as George Biggs, senior, of Sedlescombe, tanner) made his will, and in 1681 he died [5]. In his will he left a half moiety of his wares and merchandise, together with the contents in his shop, to his wife, Elizabeth, and the other moiety to his youngest son, Joseph, when he reached the age of 21, provided that she cleared the debts. To his daughter, Elizabeth, he left £25, together with a moiety of his linen and pewter, a featherbed, feather bolster, 2 feather pillows, 2 blankets, a covering, a chest and a square box. To Richard Breyn (son of his wife by her first marriage) and to Edward Martin and Ann Martin now wife of Thomas Snow (children of his wife by her second marriage) he left 12d each. His copyhold surrendered to the use of his will he left to his eldest son, George. To his son, Joseph, and his wife Elizabeth he left for one year his dwelling house and the use of the shop in the same which she now uses with remainder to George Bigge, his executor. The total value of his inventory was £296.9s.9d. [5].
1682-1691	Thos	Smith	In 1682 Thomas Smith was admitted to 'the house in Sedlescombe where George Bigge senior lived, together with Collywish, on a mortgage by George Bigge made in 1680 [4]. The same year Thomas surrendered to the use of

			his will the 'house in which he lives called The George, a tenement called Tannerswish and Bromfield in Sandlake (Battle), and a messuage and 1 acre in Sedlescombe <this property> and Collywish [4]. A deposition made in 1691 by George Bigge's son, George Bigge, describes himself as a tanner in Whatlington, aged 55. He had been born in Sedlescombe in 1636 and had lived in Sedlescombe until 1688 and thereafter in Whatlington [6]. He had therefore, presumably, stayed on as tenant after his father died, only vacating in 1688. Thomas Smith, the then owner of the property, made a mortgage of it in 1691 to Elizabeth White, widow, for £100 [4].
1691-1692	Eliz	White, widow	Became owner by default of a mortgage [4]. In 1692 she conveyed the house and Collywish to Thomas Snow of Sedlescombe, Tanner. [4]
1692-1736	Thos	Snow, tanner	[20,21] Of Sedlescombe. Owner occupier. Probably already tenant when he acquired the property in 1692. He surrendered the property (still describes as the house in which George Bigge once lived and a croft called Collywish) to the use of his will in 1703 [4]. He was still owner when the Battle manorial map was made in 1724 [17]. Thomas, described as of Sedlescombe, tanner, made his will in 1733 and died in 1736. His copyhold held of Battle Manor he left to his wife, Ann, for life with remainder to his son, Henry, entail. Sixteen acres of marshland in Pevensey (which he had bought in 1677) he left to his son, Edward. His other messuages in Brede and Guestling were left to his sons, Henry and Edward, for sale to pay his legacies [8,9]. The descent after his death has not as yet been traced.

DETAILS OF TENANCY

1560-1560+	John	Amyott	Granted a lease of the property on 1st October 1560 for 16 years [1].
c.1633-1681	Geo	Biggs (unproven)	Between 1631 and 1635 George Biggs appears in the parish tax returns for the first time [14] and it would appear that he became tenant of this property. Became owner-occupier in 1649.
1682-1688	Geo	Biggs, jnr, tanner.	Lived in the house until 1688 [6].

SOURCES marked [] at end of entry.

ESRO = East Sussex Record Office. WSRO = West Sussex Record Office.

- 1 ESRO XA3/4. 1329, 1338, 1403, 1440, 1466, 1539, 1804, 2219, 2242, 2422, 2454, 2452, 2459, 2461, 3079, 3080, 3256, 3484, 3872-3.
- 2 ESRO BAT 18, pp6, 28, 47, 101.
3. ESRO W/INV 68.
4. ESRO 19, pp 97, 105, 106, 116, 182, 200, 318.
5. ESRO W/A35.318
6. WSRO Ep II/5/19 f.2-3, 10.
7. ESRO W/B16 37v. ESRO W/INV 815.
8. ESRO W/A55 99.
9. ESRO SAU 812-38.
- 10 WSRO Ep II/5/11 f.186.
11. ESRO PAR 481/8/1
12. ESRO W/A20.10.
13. ESRO W/B6.94.
14. ESRO PAR 481/8/5 & 6
15. ESRO BAT 39
16. ESRO BAT 42, p.22 T.101 & p.25, T.111.

17. ESRO BAT 4421/9
18. ESRO XA5/2.
19. ESRO XA3/13 - rental of Iltons bath, 1367.
20. ESRO HEH BA Vol. 23 (Rentals of 1595 and 1639) Vol 24 (Rental of 1652), Vol 25 (Rental of 1680) and Vol. 99 (Rental of 1704).
21. ESRO BAT 47 - Rental of 1730.
22. SRS Vol. 56 - Lay subsidy returns 1524-1525.

**SEDLSCOMBE - SHERRALD [P41/30]
NGR TQ 7814 1792**

Tenement of Bricklehurst manor, quitrent 2d.

DETAILS OF THE PROPERTY

<1543-1543+	Ho + gdn (½a)	Described in 1543 as a messuage and garden (½a). Abuts:- E = highway Sedlescombe to Westfield; W, N = land of Vanns [P41/23]; S = land of Peny's Widow [P41/15]. [1]
<1737-1737+	Ho, gdn + orchard	Described in a deed of 1737 as a house, garden and orchard [2].
1738-1740+	Ho + gdn	In 1740 the orchard was sold off from the property [see P41/45]. [2].
<1768-1768+	Land	Described in a deed of 1768 as a piece of land with a chimney upon it [ie. the house destroyed, all but its chimney]. [2]

DETAILS OF THE BUILDINGS

LAND TAX ASSESSMENTS [1]

DETAILS OF OWNERSHIP

<1543	Thos Vann	He also owned the next property north P41/23 [1]
<1543-1543+	Mrs Waters, widow	[1]
<1609-1609+	Geo Booher	Of Westfield [1]
<1737-1737	Thos Reed, carpenter	Of Salehurst [2] He sold the property in 1737 [2]
1737-1737+	Will Weston, carpenter	Of Sedlescombe in 1737 [2].
<1768-1768	John Weston, cordwainer	Of Sedlescombe when he sold the property in 1768 [2]
1768-1768+	Isac Baker	Of Sedlescombe in 1768 [2]

DETAILS OF TENANCY

<1543-1543+	Rich Bisly	[1]
-------------	------------	-----

SOURCES marked [] at end of entry.

1. ESRO FRE 520 (ii)
2. ESRO AMS 5680.

**SEDLESCOMBE - [P41/31]
NGR TQ 7671 1881**

Copyhold of Battle manor called Wickham Milborowe, qr 5d

DETAILS OF THE PROPERTY

<1569-1569+	Ho + c18a	Described in 1569 Battle manor survey as a tenement, garden and 18 acres (of which 3 acres are adjacent the tenement and garden, the rest detached) Abutments given [1]
-------------	-----------	---

DETAILS OF THE BUILDINGS

LAND TAX ASSESSMENTS [1]

DETAILS OF OWNERSHIP

<1569-1569+	Walt	Hammond	[1]
<1724-1724+	Laur	Noakes	[1]

DETAILS OF TENANCY

SOURCES marked [] at end of entry.

1. ESRO ELT - Sedlescombe
2. ESRO BAT 42, T.75.

**SEDLESCOMBE - AUSFORD [P41/32]
NGR TQ 7875 2012**

Freehold tenement of Robertsbridge Manor called Amyotts, qr 10s.8d.

DETAILS OF THE PROPERTY

<1483-1567+ Ho,bn + c86a

Described in a 1483 grant as 2 tenements at Alkysford als Austford being 68 acres and 24 acres of Hothland [2]. Total = 90 acres.

Given in 1567 Robertsbridge manor survey as a tenement, barn, garden and 70 acres; also 12 acres called Great Hothe and 4 acres called Little Hothe. Abutments given. Total 86 acres [1]

DETAILS OF THE BUILDINGS

Destroyed

LAND TAX ASSESSMENTS [3]

DETAILS OF OWNERSHIP

<1483 Robt Bourner
1483-1483+ John Amyott

[2]

He was granted the property by the abbot of Robertsbridge in 1483 [2]

<1567-1567+ Ambr Comport
<1609-1609+ Edmd Staple, gent
<1619-1619+ Will Bishop
<1762-1762+ Will Bishop

[1]

[1]

[1]

[1]

DETAILS OF TENANCY

SOURCES marked [] at end of entry.

- 1 SRS Vol 47, T150
- 2 Calender of Robertsbridge Charters, 395
- 3 ESRO ELT - Sedlescombe

**SEDLSCOMBE - NORTH OF BRICKWALL [P41/33]
NGR TQ 7810 1820**

Copyhold of Battle manor, qr. 18d.

DETAILS OF THE PROPERTY

<1569-1569+ Ho + gdn

Described in 1569 survey of Battle manor as a messuage,
garden and close (0a.3r.). Abutments given [2]

DETAILS OF THE BUILDINGS

Destroyed

LAND TAX ASSESSMENTS [1]

DETAILS OF OWNERSHIP

<1569

Comber

His heirsheld the property in 1569

DETAILS OF TENANCY

SOURCES marked [] at end of entry.

1. ESRO ELT - Sedlescombe
2. ESRO BAT 42, T88

**SEDLSCOMBE - ADJ TO BRICKWALL [P41/34]
NGR TQ 7810 1810**

Tenement of Battle manor called Motkins, qr 2s.6d

DETAILS OF THE PROPERTY

<1460-1460+	Ho + land	Described in a court case brought in 1462 as a messuage and lands adjoining in Sedlescombe [3]
<1569-1569+	Ho, bn + c3a	Described in 1569 Battle manorsurvey asa tenement, barn and 3 closes of pasture containing 3 acres [2]

DETAILS OF THE BUILDINGS

Destroyed

LAND TAX ASSESSMENTS [1]

DETAILS OF OWNERSHIP

<1460-1460	Thos Motkin	He died on 14th October 1460. Possessions at time listed as 2 beds, 2 brass pots, 2 brass <i>pattella</i> , 2 iron <i>furns</i> , 1 ver, 1 andiron, 3 candelabra, 6 plates, 4 tin bowls, 1 frying pan, 1 <i>calsoyam</i> , 1 gridiron, 1 tripod, 1 pothanger, 2 clothes, 3 towells, 1 <i>hichell</i> , 2 sacks, 1 road saddle, 1 pack saddle, 1 wheat sive, 1 pipe cocker, 1 halfpipe, 2 herring barrels, 1 tan vat, 2 chests, 1 cart withwheels, 2 court pods, 1 ladder and 1 almery. The property was claimed by hisson, Stephen, but a case was taken out against him by Robert Motkin claiming that Thomas was not possessed of the property at the time of his death. Outcome not known [3]
<1569	Steph Vystonden	His heirs held the property in 1569 [2]

DETAILS OF TENANCY

SOURCES marked [] at end of entry.

1. ESRO ELT - Sedlescombe
2. ESRO BAT42, T89
3. ESRO Transcripts of Battle Abbey documents at the Henry Huntingdon Library, being Battle abbey Court Roll for 31st April 2 Ed IV

**SEDLSCOMBE - NORTH OF HARRIET HOUSE [P41/35]
NGR TQ 7820 1794**

DETAILS OF THE PROPERTY

<1367-1532+	Ho + curt	Described in a rental of 1367 as a messuage formerly John le Heyr, quitrent 4½d x 4 [4] Described in survey of 1433 as a copyhold messuage and curtilage, quitrent 1/6d. Abuts:- S = John Nyderton [P41/11]; N = Thomas Harry [P41/3 part B]; E = Blacklands [9]. Described in 1531 and 1532 court entry as a cottage with a garden at Iltonsbath, quitrent 1/6d [3]
<1569-1654	Ho + 35a	Described in a survey of 1569 as a copyhold messuage with 1 acre of land, quitrent 18d. Abuts:- N = freehold garden of the heirs of Brown; S = messuage of the heirs of Bartholomew Smith [P41/11]. Also 34 acres of copyhold and in Sedlescomber (34 acres). Abuts:- W = Rolfes and Garranty Blacklands [for which see P41/18]; E = lands called []. [1] Described in a court entry of 1654 as a tenement and land (1a) in Iltonsbath + a piece of land called Blacklands (34a). He also held a brook called Collybrook [7]
1654-1730+	Ho + gdn	Having been admitted to the property, Peter Avanne surrendered Blacklands and Collybrook to Peter Farnden [7]. Shown on the 1724 manor map as a house + 0a.2r.19p [2]

DETAILS OF THE BUILDINGS

LAND TAX ASSESSMENTS

DETAILS OF OWNERSHIP

<1367	John le Heyr	Given as a late owner in the rental of 1367 [4]
<1367-1367+	John Hucksteep	Given as the owner in the rental of 1367 [4].
<1433-1433+	Thos Harry	Given as owner in survey of 1433, when he also held the adjacent P41/3 part B [9] and given as a late owner in 1532 [3].
<1524-1531	Thos Webb	Alice, wife of Thomas Webb (and late the widow of Thomas Harry) brought this property to Thomas Webb upon their marriage. In 1524 Thomas Webb was assessed in lay subsidy at £1 [8]. She surrendered the property in 1531, no heriot because no animal [3]
1531-1532	John Barker	He acquired the property in 1531 and surrendered the property in 1532 [3]
1532-1534	Robt Avanne	Described as 'the elder' he died holding the property in 1534, heriot a bullock [3].
1534-1534+	Robt Avanne	Son of Robert [3]
<1569	Law Avanne	His heirs held the property in 1569 [1].
<1595	Rich Avanne, yeoman	His heirs held the property in 1595 [5]
<1639-1639+	John Petman	[5] [He probably held in the right of his wife, widow of Richard Avanne]

<1652	Pet	Petman	[5,7] [This maybe Peter Avanne known under the then current surname of his mother, or alternatively could be Peter Avanne's guardian]
1654-1654+	Pet	Avanne	Only son of Richard Avanne, late of Sedlescombe, yeoman. Being of full age, he was admitted in 1654 [7]
<1680-1680+	Pet	Hedger, gent	His heirs are given as owners in 1704 [5]
<1724-1730+	Will	Hart	Given in an update to 1569 survey and shown as the owner on the map of 1724 and rental of 1730 [1,2,6]
>1724	Dan	Wood	[2]

DETAILS OF TENANCY

SOURCES marked [] at end of entry.

1. ESRO BAT 42, T94
2. ESRO BAT 4421/9.
3. ESRO XA3/4, 2887/1, 2856, 2825/1. Court records.
4. ESRO XA3/13 - rental of Iltonsbath, 1367.
5. ESRO HEH BA Vol. 23 (Rentals of 1595 and 1639) Vol 24 (Rental of 1652), Vol 25 (Rental of 1680) and Vol. 99 (Rental of 1704).
6. ESRO BAT 47 - Rental of 1730.
7. ESRO BAT 18.
8. SRS Vol. 56 - Lay subsidy returns 1524-1525.
9. ESRO BAT 40.

**SEDLSCOMBE - Adjacent to Sedlescombe Bridge [P41/36]
NGR TQ 7832 1770**

Copyhold of Battle manor, quitrent 8d.

DETAILS OF THE PROPERTY

<1367-1367+	Ho	Described in 1367 rental as Robert Cole for his own messuage let to farm [6]
<1433-1433+	Cot?	Described in survey of 1433 as a garden built upon, now in the lords hands but used to pay 11d rent, but now ground built upon. Abutments:- E (recte W) = road from Iltonsbath to Westfield; W (recte E) The Abbots land; N (recte S) land of Robert Morrys [P41/29] [4]
1444-1444+	Gdn	In a grant by the lord to a new tenant made in 1444 the property is described as a garden called Coleshagh (Coles Hall) in Sedlescombe next to the Bridge at Iltonsbath, granted for 8d per year, but the tenant is to give 4d but no more because he will build [upon it]. [4]
<1569-1569+	Cot + 4½a.	Described in a court entry as a cottage and garden in Iltonsbath and a parcel called Coldwissh. Also included was a messuage, curtilage, garden and croft in Iltonsbath [P41^] [3] Described in the 1569 survey as a copyhold cottage and two gardens (½ acre) in Sedlescombe, quitrent 8d. Abuts:- north, east = meadow called Collywish; south = a riverulet; also a meadow called Collywish (4a) in Sedlescombe, quitrent 3/1d. Abuts:- north = messuage of John Philpot [P41/29]; south = cottage and garden of said William and a riverulet; east = lands called Blacklands [1].
<1595-1730+	Cot + 2 gdn	Collywish separated from this property and attached to P41/19. Described in the rentals as a cottage and two gardens, quitrent 8d [7]. Shown on the manor map of 1724 as a house, an outhouse set well back from the road + 0a.2r.10p. [2]

DETAILS OF THE BUILDINGS

LAND TAX ASSESSMENTS

DETAILS OF BUILDINGS

1662-1665	2 flues, but 1	House assessed at 2 flues (reduced to 1 flue) in the 1662/1665 hearth tax return [10]
-----------	----------------	---

DETAILS OF OWNERSHIP

<1433	Avan	Smith	Given as a late owner in 1433 [4]
<1367-1367	Robt	Coles	Given as a late owner in the 1433 rental and as the owner in the 1367 rental [4, 6]
<1433-1444		In Lords Hands	[4,5]
1444-1444+	Thos	Seyr	Granted this property by the lord in 1444 on condition he builds upon it [5].

<1559-1559+	Will	Egingworth	In 1559 William Egingworth otherwise Gibbon surrendered the property to the use of his will and his wife Christine admitted for life [3]
<1561-1561+	Chris	Egingworth	Christine Egingworth otherwise Gibbon, who had a life interest in this property carried out a complex series of settlements in 1561, the result of which was that she surrendered the property to John Freman in 1561, who immediately surrendered it back to her for life with remainder to John Broke and his heirs [3]
<1569-1569+	Will	Broke	Given as the owner in the survey of 1569 [1].
<1595-1595+	John	Brigden	[7]
<1639-1665+	God	Foster	[7] In 1657 he surrendered the property to the use of his will [9] He was assessed at 2 flues (but reduced to one flue) in the 1662/5 hearth tax return [10]
<1680-1680+	Rich	Foster	[7]
<1704	Geo	Merrell	His heirs held the property in 1704 [7]
<1724-1730+	John	Reed	[1,2,8]

DETAILS OF TENANCY

<1662-1665+	God	Foster	Owner occupier. He was assessed at 2 flues (but reduced to one flue) in the 1662/5 hearth tax return [10]
-------------	-----	--------	---

SOURCES marked [] at end of entry.

1. ESRO BAT 42, T102 and T103.
2. ESRO BAT 4421/9.
3. ESRO XA3/4. Court roll entry 3394-3398, 3535-3542 (see also entries 3524-3531).
4. ESRO BAT 39 - 1433 survey.
5. ESRO XA3/^ . Court Roll entry 1673.
6. ESRO XA3/13 - rental of Iltons bath, 1367.
7. ESRO HEH BA Vol. 23 (Rentals of 1595 and 1639) Vol 24 (Rental of 1652), Vol 25 (Rental of 1680) and Vol. 99 (Rental of 1704).
8. ESRO BAT 47 - Rental of 1730.
9. ESRO BAT 18.
10. ESRO XA5/2 - Hearth tax return.

**SEDLSCOMBE - KILLINGHAM [P41/37]
NGR TQ 7846 1938**

Tenement held of a manor owned in 1629 by Sir John Wildgoose at qr 6d.

DETAILS OF THE PROPERTY

<1698-1698+	Ho + c33a	Described in a mortgage of 1698 which includes other lands as amessuage and 20 acres called Killingsams with 13 acres of wood adjacent to Killingsams [3]
<1758	MERGED	A map of Castlemans Farm (P41/38) shows this property as merged into that 218 acre farm, including a toft called Killingsams with no houses shown upon it [4]

DETAILS OF THE BUILDINGS

House		
1622	Fixtures	A 1622 lease lists the following fixtures within the house: 1 lock on the hall door, 1 lock to the chamber door over the hall, a chimney plate of iron almost round in shape, q wooden oven door, 2 strong iron casks in the hall and other wooden ones, 1 hanging shelf with ledges on either side, 2 benches of planks, 1 ledge nailed to the mantel, a shelf nailed to the girder over it, 1 shelf in the inner buttery [2]
Barn		
1623	Barn built	[2]
1648	Repairs to barn	[2]

LAND TAX ASSESSMENTS [1]

1731	£6	Killingham
------	----	------------

DETAILS OF OWNERSHIP

<1622-1644+	John Everenden	[2] In 1622 he leased out the property for 13 years: list of fixtures included (see above) [2]
<1698	Thos Frewen, clerk	Of Northiam [3] By 1989 he was dead, in which year his executors mortgaged this and other property in Sedlescombe [3]
<1731-1731+	Mr Tomlin	He also owned Castlemans Farm (P41/38) into which this became merged [1]
<1758	MERGED	

DETAILS OF TENANCY

<1644-1644+	Gdmn Creasic	In 1644 he paid his rent and tithes for this property [2]
<1731-1731+	John Elliott	
<1758	MERGED	[2]

SOURCES marked [] at end of entry.

- 1. ESRO ELT - Sedlescombe
- 2. ESRO FRE 520

3
4

ESRO AMS 2091
ESRO SAS/ACC/1137

**SEDLSCOMBE - CASTLEMANS [P41/38]
NGR TQ 7776 1874**

Includes a tenement of Crowhurst manor being either 80 or 86 acres called Bakers, qr 1s.5d. [M56/4] + tenement of Battle manor called Scotsdown, qr

DETAILS OF THE PROPERTY

<1758-1758+ Ho(?), bldgs + c218a Shown in a map of the farm dated 1758 as a barn, forstalland building called Castlemans, a house and barn called Little Castlemans, a toft called Killinghams and a barn called Streeters, being 218a.2r.32p. Abutting owners shown. The farm includes fields called Scotsdown and The Bartletts, the later being 21 acres [4]

DETAILS OF THE BUILDINGS

House [Bakers]

1588-1590 In decay In 1588 it was reported that 'the mansion house which anciently stood here is in decay and no other has been rebuilt' [5]
Recorded in 1590 that 'the house on Bakers is down [deleted] ruinous [added] [5]

Windmill

1662 Reference to timber for the windmill at Castlemans

LAND TAX ASSESSMENTS [1]

DETAILS OF OWNERSHIP

<1554-1554	John	Ensyng, gent	Owner of Bakers. He sold the property [5]
1554-1569	Phil	Chute, gent	Bought the property in 1554 [5] and died holding it in 1569 [5]
1569-1584	Anth	Chute, gent	Son and heir of Phillip [5]. His death was presented in 1584 [5]
1584-1588	Geo	Chute	Eldest son and heir of Anthony [5]. He sold the property in 1588 [5]
1588-1588+	John	Downton, gent	Acquired the property in 1588 [5]
<1666	Thos	Sackville	He is given as owner of Bakers in a Crowhurst manor rental of 1666, but it could be an out-of-date entry [5]
<1661-1661+	Walt	Everenden	In 1661 Walter paid tithes for Castlemans, Mabbs, Killinghams and all his other lands in Sedlescombe [2]. He was also renting land called Bothurst (P41/9).
<1736-1736	Eliz	Coleman, widow	Her death was presented in the Crowhurst manor court in 1736 [5]
<1765-1765+		Coleman, wid	She is given as owner in the 1765 Crowhurst manor rental [5]

DETAILS OF TENANCY

SOURCES marked [] at end of entry.

1. ESRO ELT - Sedlescombe
2. ESRO FRE 520

- 3 ESRO AMS 2091
- 4 ESRO SAS/ACC/1137
- 5 ESRO RAF - Crowhurst manor documents

**SEDLSCOMBE - GREAT SANDERS [P41/39]
NGR TQ 7795 1969**

DETAILS OF THE PROPERTY

<1800-1800+	Ho, bldgs + c44a	Described in a land tax redemption list of 1800 as a messuage or dwelling called Great Sanders, stable, coach house, barns, buildings + c44 acres [1]
<1845-1845+	Ho, bldgs + c734a	Given in printed sale particulars in 1845 as a freehold estate called Great Sanders in Sedlescombe, Ewhurst and Whatlington, being a house, farm buildings and 734 acres [3].

DETAILS OF THE ESTATE

1800	9 Hos, bldgs + c1,176a.	<p>A Certificate for land tax redemption lists the Great Sanders Estate at that date as comprising the following properties:-</p> <ol style="list-style-type: none">1. Messuage or dwelling called Great Sanders, stable, coach house, barns, buildings + c44 acres in owner occupation, assessed in land tax as 'part homestall etc', £2:18:7d.2. Two messuages and buildings + c270 acres, called Allsford Farm and part Homestall in Sedlescombe and Ewhurst in own occupation, assessed in Sedlescombe land tax as 'late Smiths' £12:9:9d. and in Ewhurst as 'late Smiths' £1.3. Messuage, buildings + 92 acres in Sedlescombe called Hurst Farm in own occupation, assessed in land tax as 'Hurst Farm' £7:8:0d.4. Messuage, buildings + 97 acres plain and wood called 'Beech Farm' in Sedlescombe and Whatlington in own occupation, assessed in Sedlescombe land tax as 'Beech Farm, himself £2:6:3d. and in Whatlington as 'James Bishop occ. Edward Ades £2:11:0d.5. Farm called Chittlebirch being two messuages or cottages, buildings + 43 acres plainland in Sedlescombe and Ewhurst assessed in Sedlescombe land tax as 'do. late Mantles' £3:17:1d and in Ewhurst as 'self' £1:8:0d.6. Messuage, buildings + c40 acres called 'Durhamford als Tanhouse' in occupation Mrs Eldridge in Sedlescombe assessed in land tax as James Bishop, junior, occupation Richard Eldridge £4:12:6d.7. Messuage, buildings and farm + woodland in Battle (90 acres) occupation William Gibbs, assessed in Battle land tax as 'James Bishop, occupation William Gibbs' £3:3:9d.8. Five Hundred Acres of woodland in Sedlescombe and Ewhurst in own occupation assessed in Sedlescombe land tax as 'James Bishop, self' £3:1:8d, and in Ewhurst as 'James Bishop, self' £3:12:0d. [1]
------	-------------------------	---

DETAILS OF THE BUILDINGS

1845	Engraving	Sale particulars of 1845 include an engraving showing a front view of the house. Also given are details of the interior [3]
------	-----------	---

LAND TAX ASSESSMENTS [1]

DETAILS OF OWNERSHIP

<1632-1632+ Will Bishop [2]

DETAILS OF TENANCY

<1800-1800+ Owner-occupation [1]

SOURCES marked [] at end of entry.

1. ESRO ELT - Sedlescombe, including a certificate for land tax redemption dated 1800
2. SAC Vol 52, p.96
3. ESRO SAY 2815

**SEDLSCOMBE - FOOTLANDS [P41/40]
NGR TQ 7705 2043**

DETAILS OF THE PROPERTY

DETAILS OF THE BUILDINGS

LAND TAX ASSESSMENTS [1]

DETAILS OF OWNERSHIP

<1632-1632+	John	Darby	[2]
<1676-1676+	Will	Darby	[3]

DETAILS OF TENANCY

SOURCES marked [] at end of entry.

1. ESRO ELT - Sedlescombe
2. SAC Vol 52, p.96
3. CKS U269, T127 - abutment

**SEDLSCOMBE - BREDE BARN or MABBS [P41/41]
NGR TQ 7895 1844**

DETAILS OF THE PROPERTY

<1698-1700	Ho + c15a	Included in amortgage of properties, where it is described as a messuage and 13 acres of plainlands and 2 acres of adjacent woodland called Mabbs [2]
1700-1700+	Ho + c13a	When sold in 1700 the 2 acres of woodland were not included, the property being described as a messuage and 13 acres called Mabbs [3]

DETAILS OF THE BUILDINGS

LAND TAX ASSESSMENTS [1]

DETAILS OF OWNERSHIP

<1698-1698	Thos	Frewen, clerk	Of Northiam at his death [2]
<1700-1700	Walt	Everenden	Of Framfield when he sold the property [3]
1700-1700+	Edw	Coleman	[3]
<1758-1760+	Rich	Davies +	
	Geo	King	[4,5]

DETAILS OF TENANCY

SOURCES marked [] at end of entry.

1. ESRO ELT - Sedlescombe
2. ESRO AMS 2091
3. ESRO AMS 1573
4. ESRO SAS/ACC 376 -abutment to map dated 1760
5. ESRO SAS/ACC 1157 - abutment to mapdated 1758

**SEDLSCOMBE - SCHOOL [P41/42]
NGR TQ 7800 1830**

Wasteland plot

DETAILS OF THE PROPERTY

1731-1731+ School

In 1731 a lease of a piece of wasteland in Sedlescombe Street was assigned for the purpose of building a charity school thereon [2]. The school was built.

DETAILS OF THE BUILDINGS

1731 School built

LAND TAX ASSESSMENTS [1]

DETAILS OF 'OWNERSHIP'

<1731-1731 Josh Mercer

Of Maidstone in 1731 when he assigned the 100 year lease on this property at 6d p.a. [2]

1731-1731+ Trustees

The trustees were given as Rev Thornton and others when the lease was assigned to them [2]

DETAILS OF TENANCY

SOURCES marked [] at end of entry.

1. ESRO ELT - Sedlescombe
2. ESRO AMS1582

**SEDLSCOMBE - HURST [P41/43]
NGR TQ 7881 1905**

DETAILS OF THE PROPERTY

<1760-1760+	Ho, bldgs + land	Map of 1760 shows the property as a house, barn, outbuilding, 2 other buildings and lands (total acreage not given) being part of the estate of William Bishop esq. Abutting owners shown. [2]
<1768-1780+	Ho, bldgs, 71a + wood	Lease of 1768 gives the property as a messuage, barn, stable, buildings, closes, lodge, garden, orchard and 71 acres of land called Hurst als Hurst Churchlands. The lease excluded woodland [7] Same description given in lease dated 1780, except a stall added [8]
<1843-1843+	Ho, bldgs + c184a	Given in the title award for Sedlescombe as a house, buildings + 80 acres of plainland and 104a.2r. of woodland: total 184a.2r. [9]

DETAILS OF THE HOUSE

1722	Rooms listed	Inventory gives contents of the hall, kitchen parlour, pantry, milk cellar, best beer cellar, outer cellar, hall chamber, kitchen chamber, little chamber and garret. Contents imply a closed within the kitchen chamber. Also mentions an oasthouse and barn.
	Surveyed	See ESRO HBR 1/862

LAND TAX ASSESSMENTS [1]

1731-1740	£24	
1741-1780	£25	(a parish re-assessment)
1781-1825	£48	(a parish re-assessment)

DETAILS OF OWNERSHIP

<1528-1567+	Rich	Bishop	[3,4]
<1731-1731+	Will	Bishop, esq	[1,2,3]
<1750-1750+	Hen	Bishop	Of Great Sanders (P41/39)
<1755-1780	Will	Bishop	Of Great Sanders [1,2,3]
1780-1805	Jas	Bishop	Of Great Sanders [1]
1805-1825	Geo	Bishop	A younger son who is granted this property (but not Great Sanders [3] The property was sold in about 1825 [3]
1825-1843+	Hercl	Sharpe	Of Oaklands Park. He purchased the property in about 1825 [1,3] and was still owner in 1843 [9]

DETAILS OF TENANCY

<1712-1722	Henry	Barnes	He paid poor rate for the property from 1712-1722 and died whilst tenant in 1722. Probate inventory dated 1722 survives; value £238.16s.0d [6]
1722-1723		Barns, widow	[5]
1723-1728	Jaspr	Diaman	[5]
<1731-1731+	Will	Redhead	[1] Probably tenant of the lands only as William Bishop described as 'of Hurst' in 1731 [3]
<1735-1767	Will	Young	[1] Probably tenant of the lands only as William Bishop was described as 'of Hurst House and Great Sanders' in 1756 [3]

1768-1790+	Will	Cook	[1]. In 1768 he took up a 11 year lease of Hurst at £48 p.a. [7] renewed for a further 11 years at the same rent in 1780 [8]. He also farmed Durhamford als Tanhouse [1]
<1806-1820+	Mr	Shoebridge	[1]
<1825-1825+	Mr	Mercer	[1]
<1830-1843+	Hercl	Sharpe	Of Oakelands Park, but also viven in land tax and tithe award as the owner-occupier of this property [1,9]

SOURCES marked [] at end of entry.

1. ESRO ELT, LT, LLT - Sedlescombe
2. ESRO SAS/ACC 376 - Map dated 1760
3. Lucy, B, 'Twenty Centuries in Sadlescombe' (1978), pp. 197, 238
4. SRS Vol.47, Abutments to T150
5. ESRO PAR 481/9/5
6. ESRO W/INV 1545
7. ESRO AMS 1611
8. ESRO AMS 1617
9. ESRO TDE 20 - Sedlescombe

**SEDLESCOMBE - AUSTFORD FARM [P41/44]
NGR TQ 7867 2014**

Freehold of Crowhurst manor called Asford, qr 1s.5d. (or earlier 1s.0d. + 1 lb of Cumin [M56/2])

DETAILS OF THE PROPERTY

<1590-1590+	Ho + c240a	Described in Crowhurst manor court book in 1590 as a house and 200 acres called Ausford in Sedlescombe [5] and in court book in 1592 as a house and 240 acres in Sedlescombe and Ewhurst [5]
<1611-1611+	Farm of c84a	Described in a tax assessment of 1611 as a farm called Ausford being 84 acres (? of plainland + wood?) [2]

DETAILS OF THE BUILDINGS

Destroyed

LAND TAX ASSESSMENTS [1]

DETAILS OF OWNERSHIP

<1567-1567+	Robt Sheppard	[4]
<1590-1590	Alex Sheppard, gent	He sold the property in 1590 [5]
1590-1602	Will Davy I (als Davis)	Described as of Gate (in Beckley) in 1590 when he acquired the property [5] and of Beckley in 1611 [2] He died holding the property in 1602 [5]
1602-1666+	Will Davy II	Son and heir of William Davy I
<1671	Edw Davy (als Davis)	His heirs held the property in 1671 [3]
<1736-1736	Will Bishop esq	His death holding the property presented in 1736 [5]
1736-1736+	Hen Bishop	[5]

DETAILS OF TENANCY

SOURCES marked [] at end of entry.

1. ESRO ELT - Sedlescombe
2. ESRO FRE 520 - Assessment for tax of the 15th
3. ESRO AMS 5691 - Abutments on Bodiam manor map dated 1671
4. SRS Vol. 47, Abutments to T143, 146, 150
5. ESRO RAF - Crowhurst manorial documents

**SEDLSCOMBE - THE COTTAGE [P41/45]
NGR TQ 7815 1789**

Tenement of Bricklehurst being a division of P41/30.

DETAILS OF THE PROPERTY

<1738-1738 NOT FORMED
1738-1740+ Ho

In 1738 a house was built on a divided off part of P41/30 and when sold, the divided off part was described as comprising 0a.1r.11p. Abuts:- E = Sedlescombe Street; W = Samuel Craft [P41/23]; N = William Weston [P41/30]; S = J Chapman [P41/15] [1].

DETAILS OF THE BUILDINGS

LAND TAX ASSESSMENTS

DETAILS OF BUILDING

1738 House Built

Detailed tradesmen receipts survive for the building of the house in 1738. The first payment, made by the prospective purchaser to William Weston and John Plummer was for £78/19/00d, being the first half payment which was paid 'at the raising of the house, upon a good title being made to the piece of ground whereon the said house is built'. Included was an undertaking to complete the house. The receipt is dated 7th July 1738. The next payment was for £20, then £29/01/00d, then £29 with a note stating £1 abated, giving a £158 in all. The final receipt, dated 16th March 1738 (ie. 1739) states 'of Mr Stephen Robinson at several times and in several sums £158 in full for building him a house in Sedlescombe Street and in full for the ground it stands upon and now doth belong to it' signed William Weston. Also included is an agreement, dated 15th March 1738 (ie. 1739) which states 'I do hereby promise to repaint the doors, doorcases and all other things that are now painted in the house I lately built for Mr Stephen Robinson, and also to whitewash the whole house when the said Stephen Robinson desires the same to be done, the said Stephen Robinson finding and allowing all materials for doing the same. And also to sink the well as many feet deeper as desired or til there is sufficient water to supply the house, I finding all materials for the well. As witnessed by my hand William Weston'. [1].

DETAILS OF OWNERSHIP

<1738-1738 NOT FORMED

In 1738 Thomas Reed sold P41/30 to William Weston, carpenter of Sedlescombe [1] who in 1738 built a new house and in 1740 divided off the plot upon which the new

1738-1740+	Step	Robinson	house was constructed and sold it. [1]. First owner of this divided off part: he became owner in 1738 but did not take possession until the house was completed in 1740 [1]
<1768-1768	John	Chrisford	Victualler and farmer of Northiam when he sold the property in 1768 [1]
1768-1768+	John	Russell, victualler	[1]

DETAILS OF TENANCY

SOURCES marked [] at end of entry.

1. ESRO ACC 165/910-922.

**SEDLSCOMBE - FIR TREE COTTAGE [P41/46]
NGR TQ 7817 1786**

DETAILS OF THE PROPERTY

DETAILS OF THE BUILDINGS

Surveyed

See ESRO HBR 1/1149

LAND TAX ASSESSMENTS

DETAILS OF OWNERSHIP

DETAILS OF TENANCY

SOURCES marked [] at end of entry.

1. ESRO ELT - Sedlescombe

SEDLSCOMBE - North of Brickwall House [P41/47]

Copyhold of Battle manor, quitrent 18d + a copyhold called Waterland, quitrent 20d.

DETAILS OF THE PROPERTY

Part A

- <1367-1433+ 2 Crofts Described as 2 crofts in the 1367 rental [4]
 Described in survey of 1433 as a croft called Hothdene, late William Seyr and before William Watman. Abuts:- E = Scottsdown; W = land of the same owner [see below]; N = John of Beche; S = William Baker, quitrent 12d Also a croft called Waterland late owned as the above. Abuts:- E = croft last mentioned; W = William Hucksteep; N = John a Beche; S = William Hucksteep and William Motkin, quitrent 20d [8]
- >1433 1 croft Croft called Hothdenne sold [see P41/48].

Part B

- <1367-1367+ Ho Described in a rental of 1367 as a messuage [4]
 <1433-1433+ Ho Described in survey of 1433 as a messuage and curtilage once John Hucksteep, quitrent 18d. Abuts:- N = Waterland [P41/47]; S = Thomas Motkin [P41/6 part A]; E = Croft called Adamsland [8].

Both Parts

- <1546-1546+ Ho + croft Described in a court book in 1546 as a messuage, garden, curtilage and croft called Waterland in Iltonsbath [3].
- <1554-1569+ Ho + 10³/₄a Described in a court entry in 1554 as a messuage and apputrenances in Iltonsbath, rent 1/6d + a croft called Watersland at Iltonsbath [3]
 Described in a court entry of 1560 as a messuage, garden, barn and curtilage at Iltonsbath together with a croft of bond land called Waterland [3].
 Described in Battle manorial survey of 1569 as a copyhold messuage with a garden and close of pasture (3r) in Sedlescombe, quitrent 18d. Abuts:- N = Comber's own meadow called Waterland; S = messuage of the heirs of Stephen Vystonden [P41/06]. Also a meadow called Waterland (10 acres) in Sedlescombe on the northernmost part of his house, quitrent 20d. Abuts NE, W = land of Chowle; S = heirs of Vystonden [P41/06] [1].
- <1595-1704+ Ho, gdn + mead Described in rentals of 1595 to 1704 as a messuage and garden, quitrent 1/6d + a meadow called Waterland, quitrent 1/8d [5]. The 1652 rental describes the messuage and garden as a messuage, garden and barn [5]. A court entry of 1652 describes it as a piece of land called Waterland, quitrent 20d + a messuage and garden at Iltonsbath, quitrent 18d [7].

DETAILS OF THE BUILDINGS

LAND TAX ASSESSMENTS

DETAILS OF OWNERSHIP

Part A

<1367	Will	Watman	[4]
<1367-1367+	Will	Seyr	Given as the owner in the 1367 rental [4]
<1433-1433+	Thos	Seyr	[8]

Part B

<1367	John	Potc/e/hows	Given as late owner in the rental of 1367 [4]
<1367	John	Hucksteep	His heirs are given as the owners in 1367 [4]
<1433-1433+	Will	Hucksteep	[8].

Both Parts

<1554	John	Porrett	In 1546 John Porrett is recorded as having sold this copyhold property to Richard Comber without a surrender, to the prejudice of the lord; the property was seised and the owner to respond to the lord for the issues. Whether the sale was enacted at this date is uncertain, but the manorial court books assumed Porrett was still the owner in 1554 when his kin and heirs, George Wenham, William Smith and William Young, were admitted to this property [3]. In 1560 George Wenham surrendered his one third part interest in the property to William Young, giving Young a two-thirds interest [3]. However, in 1569 the property was described as being the heirs of [] Comber, presumably the Richard Comber to whom it had been sold in 1546 [3].
<1569	[Rich]	Comber	His heirs held the property in 1569 [1,3].
<1595-1595+	John	Boyes	He held the property in 1595 [5]
<1639-1639+	Thos	Sackville, kt	He held the property in 1639 [5]
<1652-1652	Edw	Sackville	He sold the property in 1652 [7]
1652-1654	Pet	Farnden	[7] He held the property in 1652 and his heirs are given as the owners in 1680 [5] His death was presented in the court book in 1654 [7]
1654-1655+		Farnden, heirs of	Upon the death of Peter Farnden the property descended first to his wife, Lucy, and then to his nephew, Peter Farnden [7]
<1659-1659+	Pet	Farnden, gent	Nephew of Peter Farnden [7]
<1704-1730+	Jos	Mercer	Given as the owner in an update to the 1569 survey [1,5,6].

DETAILS OF TENANCY

SOURCES marked [] at end of entry.

1. ESRO BAT 42, T87 and T88.
2. ESRO BAT 4421/9.
3. ESRO XA3/4. Court records, 3264-3265, 3469.
4. ESRO XA3/13 - rental of Iltonsbath, 1367.
5. ESRO HEH BA Vol. 23 (Rentals of 1595 and 1639) Vol 24 (Rental of 1652), Vol 25 (Rental of 1680) and Vol. 99 (Rental of 1704).
6. ESRO BAT 47 - Rental of 1730.
7. ESRO BAT 18.

8. ESRO BAT 40.

SEDLSCOMBE - SCOTTSDOWNE [P41/48]

Freehold of Battle manor called Scottsdowne, quitrent 12/- + Freehold of Battle manor called Longwish + freehold of Battle manor called [Hotheden].

DETAILS OF THE PROPERTY

<1367-1367+	Land	Described in rental of 1367 as land called Scottesdowne, rent 3/- [x 4] [4]
<1433-1433+	Land	Described in 1433 survey as 4 crofts lying together called Scottesdown. Abuts:- W = John of Beche; E = Robert a Thorpe, Parsons Land and Jacobs Field; N = Church Field; S = road Iltonsbath to Brede. Rent 12/- in four quarters. Also a croft called Longwish abutting W = Blackland; E = John at Field; S = Collywish; N = road Iltonsbath to Brede. Rent nothing because included with Scottesdown [7]. Note: The 1433 survey also includes a croft owned by William Baker called Bakers Croft abutting W = Thomas Motkin; E = Robert Morris; N = Thomas Seyr [P41/47]; S = Iltonsbath to Brede road: Also a croft called Morchere abutting W = William Baker; E = Scottesdown [main part of this property]; N = Hothedene; S = road Iltonsbath to Brede. Neither of these two crofts paid rent as both were included within the rent for Scottesdown. [7].
<1554-1554+	Land	Described in a court entry when the owner paid relief for this property as land called Scottsdowne in Iltonsbeth and land called Hotheden in Iltonsbath [3]
<1569-1569+	Land	Described in Battle manorial survey of 1569 as four freehold closes called Scottsdowne, quitrent 12/- [no abutments] + a croft called Longwish (6 acres). Abuts:- W = lands called Blacklands; S = copyhold called Collywish; [N] = street leading from Iltonsbath to Brede. Also one croft called [Hotheden] containing [acres]. Abuts:- E = Scottsdowne [1].
<1595-1704+	Land	Described in rentals as 4 crofts called Scottsdowne, quitrent 12/- and lands called Longwish [no quitrent given]. Also a croft called Hotheden, quitrent 1/- [5]

DETAILS OF THE BUILDINGS

LAND TAX ASSESSMENTS

DETAILS OF OWNERSHIP

<1367-1367+	John	Raycombe	Given as the owner in 1367 rental [4]
<1433	Robt	aThorpe	[7]
<1433-1433+	Thos	Wayte	[7]
<1569-1569+		Chute	He held the property in 1569 [1]
<1595-1595+	John	Downton, gent	[5]
<1639	Pet	Farnden	[5]
<1639-1639+	Thos	Sackville, kt	[5]
<1652-1652+	Walt	Evernden	His heirs are given as the owners in 1680 and 1704 [5]
<1724-1730+	Thos	Tomlyn/Tamblin	Given as the owner in an update to the 1569 survey [1] and in

DETAILS OF TENANCY

SOURCES marked [] at end of entry.

1. ESRO BAT 42, T84-T86
2. ESRO BAT 4421/9.
3. ESRO XA3/4, 3266-3267. Court records.
4. ESRO XA3/13 - rental of Iltonsbath, 1367.
5. ESRO HEH BA Vol. 23 (Rentals of 1595 and 1639) Vol 24 (Rental of 1652), Vol 25 (Rental of 1680) and Vol. 99 (Rental of 1704).
6. ESRO BAT 47 - Rental of 1730.
7. ESRO BAT 40.

**SEDLSCOMBE - LUCKWISH [P41/49]
NGR TQ 7712 1875**

Freehold of Battle manor called Luckfish, qr 11s.9d

DETAILS OF THE PROPERTY

<1569	13a land	Described in 1569 Battle manor survey as 13 acres of land, including the site of a house which had been burnt down. By this date the land had been merged into Spilsteads Farm (P41/10)
-------	----------	---

DETAILS OF HOUSE

<1569	Destroyed	Burnt down prior to 1569 [1]
-------	-----------	------------------------------

LAND TAX ASSESSMENTS [1]

DETAILS OF OWNERSHIP

<1569	MERGED	See Spilsteads Farm (P41/10)
-------	--------	------------------------------

DETAILS OF TENANCY

<1569	MERGED	See Spilsteads Farm (P41/10)
-------	--------	------------------------------

SOURCES marked [] at end of entry.

1	ESRO	BAT 42, T76.
---	------	--------------

SEDLESCOMBE - ROSEHILL [P41/50]

DETAILS OF THE PROPERTY

DETAILS OF THE BUILDINGS

LAND TAX ASSESSMENTS [1]

DETAILS OF OWNERSHIP

DETAILS OF TENANCY

SOURCES marked [] at end of entry.

1. ESRO ELT - Sedlescombe

**SEDLSCOMBE - WIMBLETOTTS COTTAGE [P41/51].
NGR TQ 7666 2078**

Wimbletotts originated as a plot of wayside waste granted on lease by the overlords of the Rape of Hastings

DETAILS OF THE PROPERTY

<1788-1843+	Cottage	Described in 1788 wayside survey as a cottage and garden (0a.0r.26p) held at a yearly rent of 5 shillings by a [renewed] [2]. By 1843 the boundary between the wayside plot and a small field immediately behind it had been removed in order to enlarge the garden, the plot being described as a house and garden (0a.3.19p). The associated tithe map of 1841 shows a freestanding outhouse sited to the south of the house [4]
-------------	---------	---

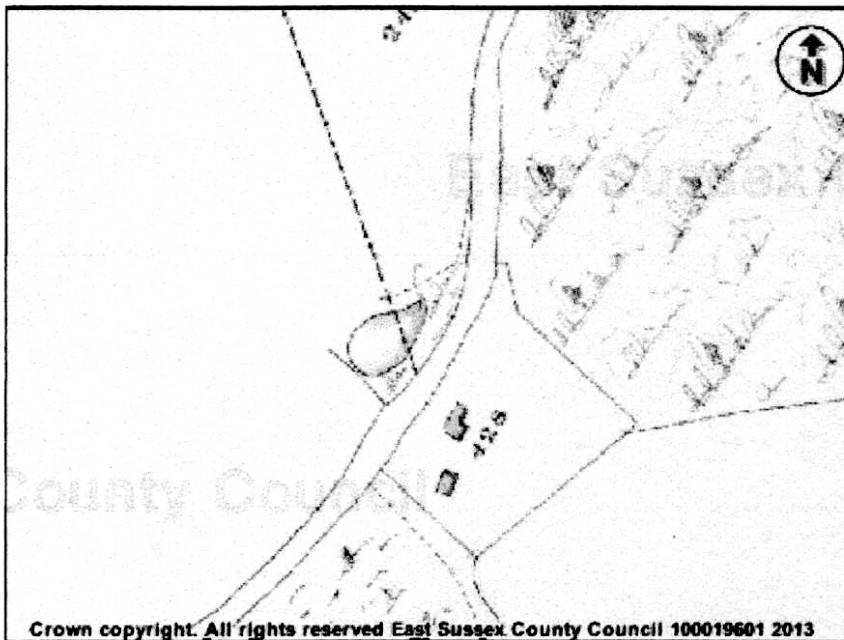

Extract from Sedlescombe Tithe Map dated 1841 [© ESCC]

DETAILS OF HOUSE

Surveyed See ESRO HBR 1/1762

LAND TAX ASSESSMENTS [1]

DETAILS OF 'OWNERSHIP'

<1788-1788+	Thos Noakes, lab	Of Sedlescombe in 1788: he held at a yearly rent of 5s.0d by a [renewed] lease dated 1782 for the term of 20 years: he occupied the house [2].
<1834-1834	Tilden Smith I	Of Vinehall in Mountfield. He also owned adjacent Footlands Farm. He died in 1834 leaving as heirs five sons between which the Vinehall Estate was shared [3]
1834-1843+	Rich Smith	The 96-acre Footlands Farm (including this cottage) formed part of the estate apportioned to Richard Smith, who was still the owner in 1843 [3,4].

DETAILS OF TENANCY

<1788-1788+ Thos Noakes, lab

SOURCES marked [] at end of entry.

1. ESRO ELT - Sedlescombe
2. ESRO CHR 18/1, CHR 18/9 and 18/13
3. ESRO SAS AN 189 - Will of Tilden Smith dated 1834, proved 23/1/1835
4. ESRO TDE 20, Plot 428.

SEDLSCOMBE - [P41/U1]

Unidentified property held of the manor of Battle

- 1a Battle court roll 1530. Reports that the tenants of land late Robert Twytt at Iltonsbath had not done fealty [ESRO XA3/4 - 2797/5].
Battle court roll 1540. Edward Twytt acknowledges the tenure of a messuage and adjoining garden in Iltonsbath which descended to him after the death of his father Robert Twytt [ESRO XA3/4 - 2990/2].
- 1b The following entry relates to property which Elizabeth Peny, the widow of William Peny, appears to have held in her own right.
1546 death of Elizabeth Peny holding two parcels of Brookland at Iltonsbath, no heriot no animal. John Bishop, younger son of William Bishop the elder, and wife Joan, Elizabeths daughter and heir, admitted. Also for a copyhold messuage, curtilage and garden at Iltonsbath, quitrent 1.6d. No heriot no animal which descended to John Philpot, then 7 years old, being the grandson of Elizabeth Peny. John's mother Juliana Philpot admitted as guardian [ESRO XA3/4 - 3079, 3080].
- 1c Court roll 1521 Death of Thomas Egingworth als Gibbon holding a cottage with adjoining garden at Iltonsbath, surrendered to wife Joan for Life [ESRO XA3/4 - 2589].
- 1d In 1559 William Egingworth surrendered to the use of his will a messuage, garden, curtilage and croft of bondhold in Iltonsbath, and his wife, Christene was admitted [ESRO XA3/4, 3396]. A 1561 settlement by Christine Egingworth als Gibbon to self for life with remainder to John Abroke - the property was still called a messuage, curtilage, garden and croft of bondhold in Iltonsbath. [ESRO XA3/4 - 3536- 3540]. These entries should not be confused with P41/36 which is included in the surrender and in the settlement.
- 1e Court entry of 1548 refers to the south abutment of P41/3 as a messuage and garden late Richard Harrys. This is probably P41/35 (which was owned at one time by the Harrys family), but it could be a messuage standing on the plot between the two - all depends on whether the messuage which one stood on the plot between the two still survived at that date, or whether the house had been demolished and the land merged into P41/3. [ESRO XA3/4, 3116].
- 1f Court entry for 1552 noted that George Bachelor died siezed of a freehold garden at Iltonsbath: heriot a two-year-old heifer. [ESRO XA3/4, 3228]. The property has not been identified.

Unidentified entries from Battle Court Records, 1460s

- | | | |
|----|-------|--|
| 2a | 1460. | Richard Harrysurrendered a bondhold? cottage with garden adjacent; Sandlake; at Teltons bath in Sedlescombe, to Robert Duke, to hold of himself and his wife, Alice. [ESRO XA3/4, entry 1847.] |
| 2b | 1462 | John Hammond and wife Joan surrender a messuage, garden and 2 crofts, formerly Robert Fyshe, in Sedlescombe, to said Robert Fyshe. [ESRO XA3/4, entry 1881] |
| 2c | 1463 | Death of Joan, wife of David Daniel presented holding a tenement with garden adjacent (1a) at Iltons bath, rent 1/6d. John Daniel is the son and heir of David and Joan Daniel and is admitted. [Then something about William Baker of Brede his heirs and assignees, but largely illegible - probably Daniel is selling to Baker]. [ESRO XA3/4 entry 1900]. |

- 1658 Elizabeth Weeks widow and her son, of Udimore, surrender a copyhold messuage heretofore called a smiths forge and garden, part of a tenement now or late Moses Ticehurst and his wife, in Iltons bath, to the use of Thomas Weeks of Sedlescombe and his heirs [ESRO BAT 18]
- 1659 In 1659 Thomas Weeks of Sedlescombe made a conditional surrender of this property to George Standen of Salehurst, tanner [ESRO BAT 18]
- 1662-1665 Thomas Weeks is assessed in the hearth tax at 2 flues where he is noted as poor [ESRO XA5/2].

A rental of Bricklehurst manor made 1609 lists the following Sedlescombe property:-

John Sackville, esq a messuage and 6 acres late Goddard Bexleys. rent 2d.

The same John Sackville for a messuage late Goddard Foster, 4d

John Douton for lands called Jefferies, sometime Richard Bishop of Hastings, 4/6d

Robert Weeks of Brede for the other moiety of the said Bothurst, now in the occupation of Barscombe Frecham
- Now Located P41/8.

Heirs of John Bishop late of Ewhurst for certain lands called Perretts, now in the occupation of [] Baker of
Sedlescome, 6d.

Richard Baldock for a messuage late Thomas Booche, rent 2d.

Joanana Avan for a messuage sometime Waghorns, Now located P41/28.

George Booche of Westfield for a messuage sometimes Waters, 2d. Now located P41/30.

Mary Avan, widow for a toft sometime a messuage, 4d.

The copy of the rental which survives is short by a 3/- rent and includes only 9 Sedlescombe entries, though
there should be 10 according to the 1543 rental.

[ESRO FRE 520 - ii]